

1264 1264

138

Cadastral Sheet G.3 B. 53C  
Ward of Naparima 37c  
County of Victoria

To be brought under the provisions of the  
Real Property Ordinance .

Process ~~1264~~ 66668

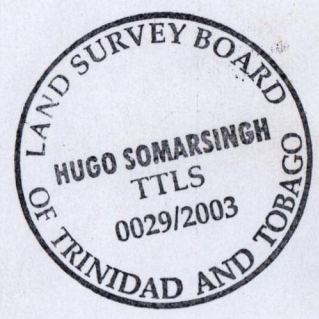
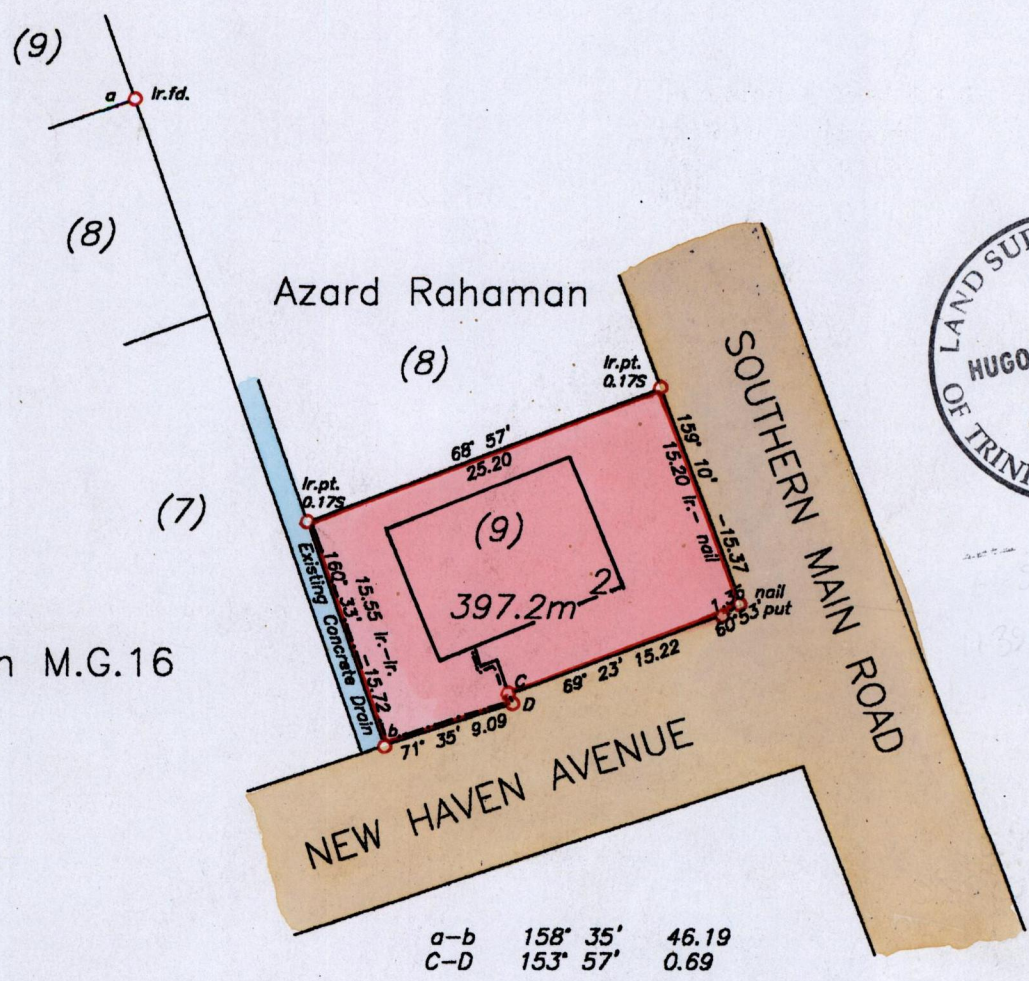

See Plan M.G.16

Approved by  
*[Signature]*  
Director of Surveys  
2003.10.13

Bearings are Cassini Grid based on Solar Observation

Note: To obtain compass bearings add/subtract minutes

○ Denotes Iron put unless otherwise stated

SCALE:- 1/500  
Distances are in metres

PLAN of a Parcel of land coloured pink in the Ward of Naparima  
Containing three hundred and ninety seven point two square metres

Surveyed by me, with due authority on 14th July 2002 for Mervyn Edwards  
In accordance with Reg. 25 (1) of the Land Surveyors' Regulations 1998, I certify that this plan  
is correct.

Checked by *[Signature]* 25 Sept 03

*[Signature]*  
Trinidad & Tobago Land Surveyor  
20th August 2003

Entered on *[Signature]*  
20-06-13