

1264

1

To be brought under the provision of the
Real Property Ordinance

Reg. Deed No. 14636 / 1993

Ward of Savana Grande
County of Victoria
Cadastral Sheet (G.4.N) 54.D.
4/a
PRINCES TOWN

Process SD#66390

cannot locate

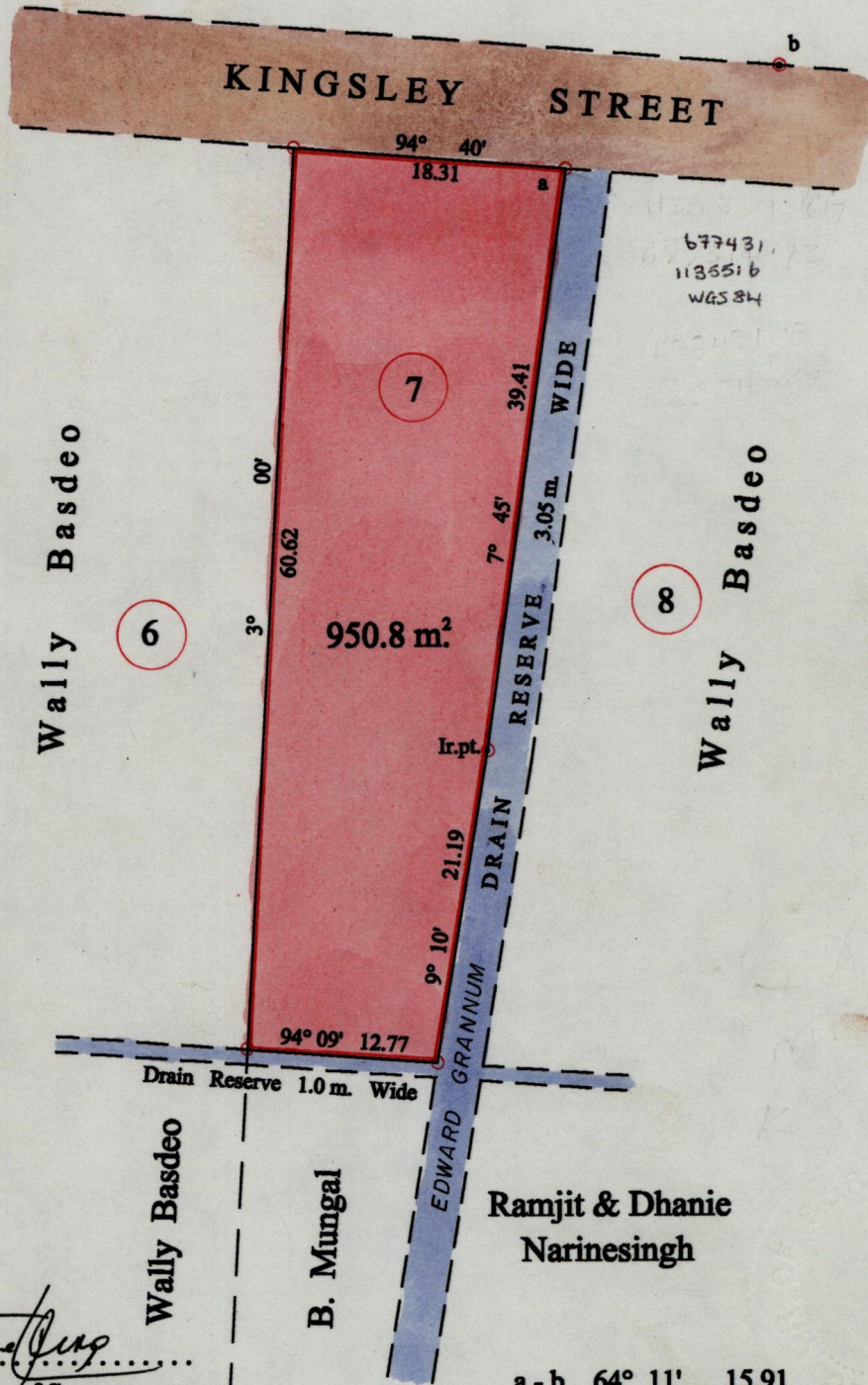

Approved *[Signature]*
Director of Surveys

2001.07.08

○ Denotes Iron found unless stated otherwise.

Note: Bearings are cassini grid based on solar observations

SCALE : 1:500

Distances are in metres

PLAN of a Parcel of land coloured pink in the Ward of Savana Grande

Containing nine hundred and fifty point eight square metres

Surveyed by me, with due authority, on the 21st. July 2000 for Mrs. Lynette Ryan

In accordance with Rule 25 (1) of the Land Surveyors Regulations 1998

I certify that this plan is correct.

Checked by *[Signature]*

Entered *[Signature]* 8/03
Trinidad & Tobago Land Surveyor

