

No 11283

1249 Vol 2

7

R.P.O. Vol. 190
C.T. Vol. 2474

Fol. 381
Fol. 21

Ward of Siparia
County of St. Patrick
Cadastral Sheet 6.13.G. $\frac{65F}{2/c}$

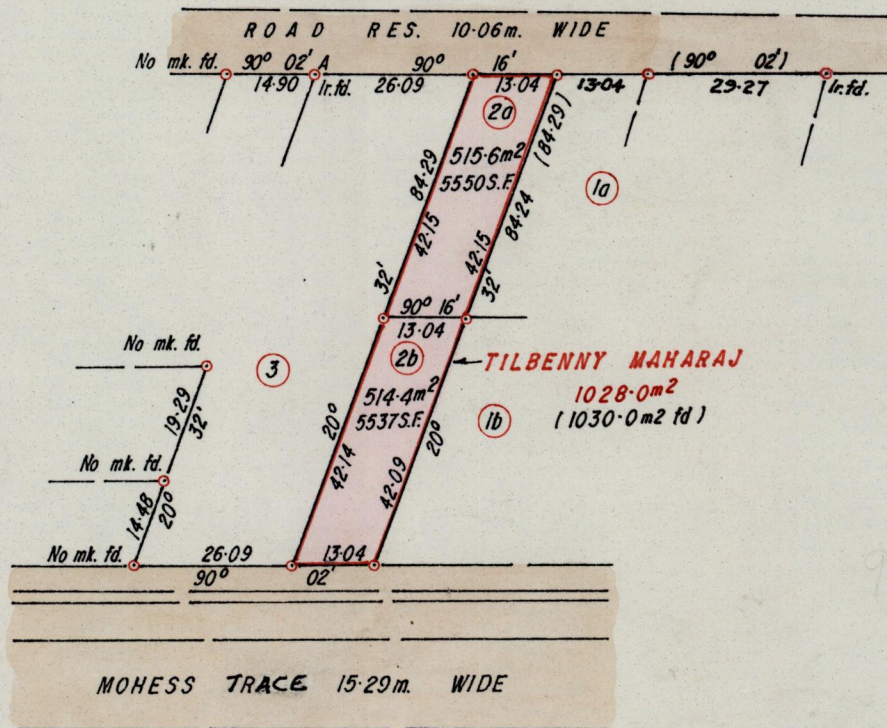

Bk. 915 / 122 B Bk. 1211 / 144

Approved

[Signature]

Director of Surveys

○ Denotes Iron put. 2880.1.20

Bearings are based on Solar Obs

Note: To obtain compass bearings add/subtract

SCALE 1 / 1250
minutes

Distances are in metres

PLAN of 2 Parcelsof land coloured pink in the Ward of Siparia
Containing together one thousand and thirty square metres
Surveyed by me, with due authority, in May 1997

I certify that I have complied with rule 76 under section 14(2)(d) of the
Land Surveyors' Ordinance 1952, and that this plan is correct.

Checked by *NR 99/12/14*

Naveed Abdul T.T.L.S.

Entered

Land Surveyor, Trinidad *20th January 1999*