

1249<sup>2</sup>

49

R.P.O. Vol. 235 Fol. 369  
C.T. Vol. Fol.  
U.P.R.N. No.

Cadastral Sheet D.10.M. <sup>34 F</sup>/<sub>27d</sub>  
Ward of San Rafael  
County of St. George

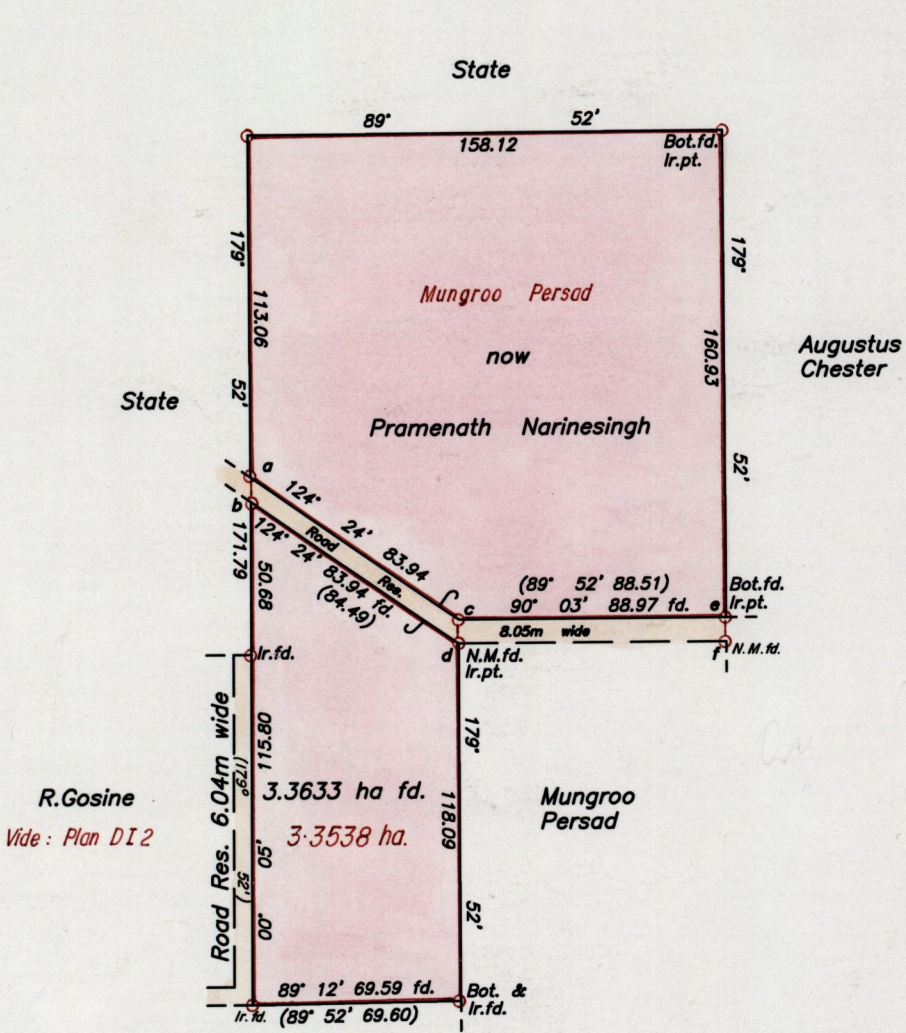

R.Gosine  
Vide: Plan DI 2

Sooknunun Mahradge  
then  
D. Farrell

Sta.	Bearings	Dist.
a - b	179° 52'	8.05
c - d	179° 52'	8.05
e - f	179° 52'	8.05

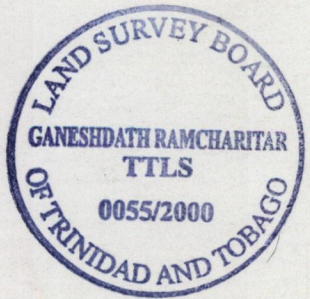

Approved. *[Signature]*  
Director of Surveys 5.4.2000

SCALE 1:2500  
Distances are in Metres

○ Denotes Iron put except otherwise stated.

Bearings are based on solar observations

Plan of a Parcel of Land coloured pink in the Ward of San Rafael  
Containing three point three six three three hectares  
Surveyed by me, with due authority in October 26th. 1999

In accordance with Rule 25 (1) of the Land Surveyor's Regulations 1998, I certify that this plan is correct.

Checked by. *[Signature]*  
Entered. . . . . Trinidad & Tobago Land Surveyor. . . . . 20 . . . . .  
9/02/2000

GANESH DATH RAMCHARITAR  
LAND SURVEYOR