

1249

REMAINING PORTION

238 2333

R.P.O. Vol. 91 Fol. 603
C.T. Vol. 2327 Fol. 257
U.P.R.N. No.

Ward of Tamana
County of St. Andrew
Cadastral Sheet E6B&F. 35B
3/a 83/c

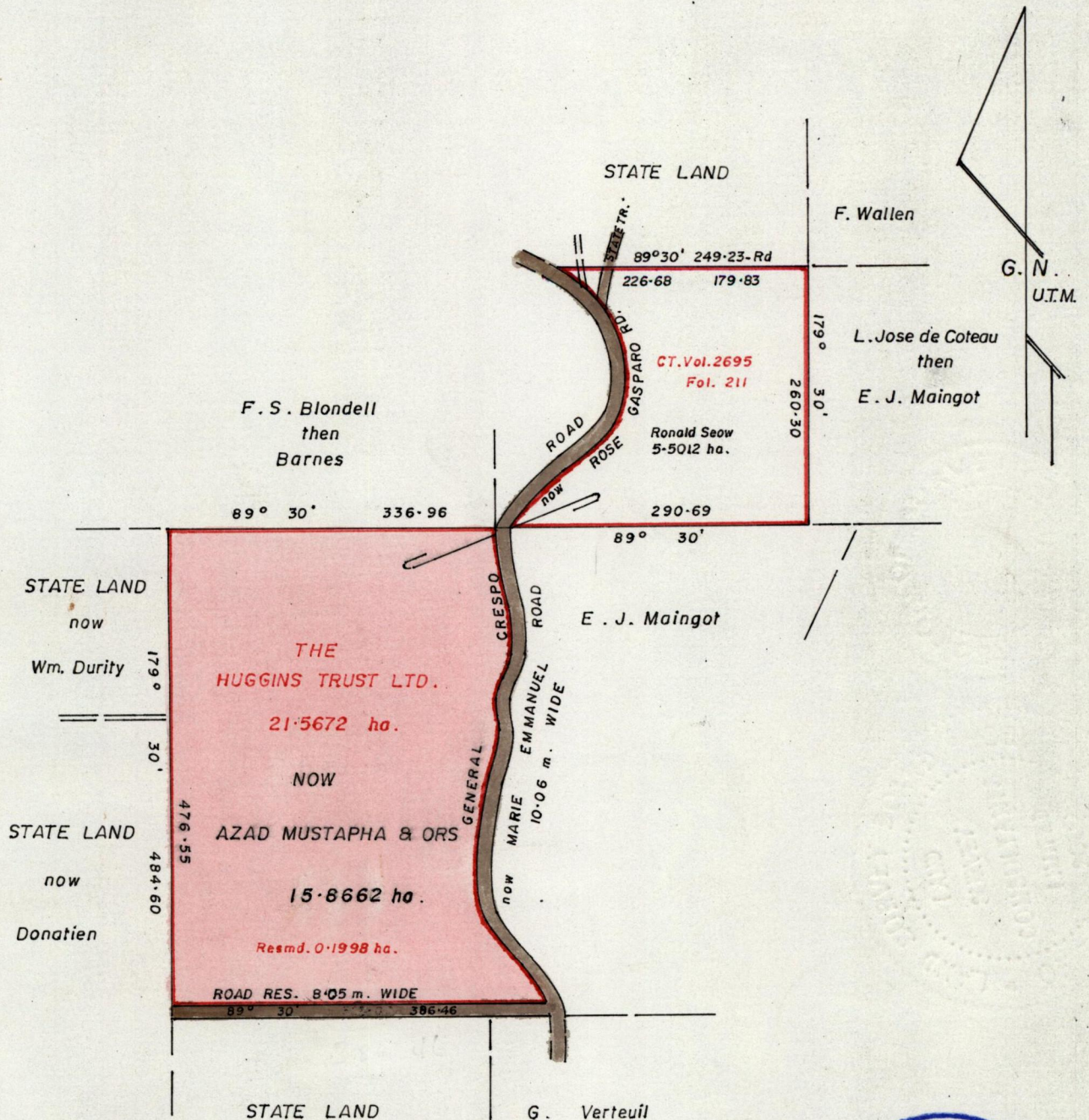

Approved by

[Signature]

Director of Surveys 7
2007-03-21



SCALE:- 1/6336

Distances are in metres

Note: To obtain compass bearings add/ subtract 30 minutes

This is a true copy of a diagram of twenty six point five six seven two hectares originally transferred granted to The Huggins Trust Ltd. shewing a portion coloured pink and containing fifteen point eight six six two hectares being the remainder after one (1) previous transfer of another portion of land

In accordance with Rule 25 (1) of the Land Surveyors' Regulations 1998, I certify that this plan is correct.

Checked by *[Signature]* 21/3/01

[Signature] T.T.L.S.

Entered on.....

Trinidad & Tobago Land Surveyor..... 14/11/00