

1249

214

B N^o 4063

R.P.O. Vol.
C.T. Vol. 3958

Fol.
Fol. 507

Ward of Diego Martin
County of St. George
Cadastral Sheet A.19.J

3D E 13A
4/d

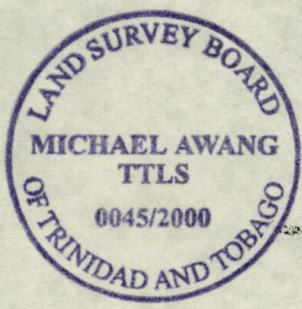
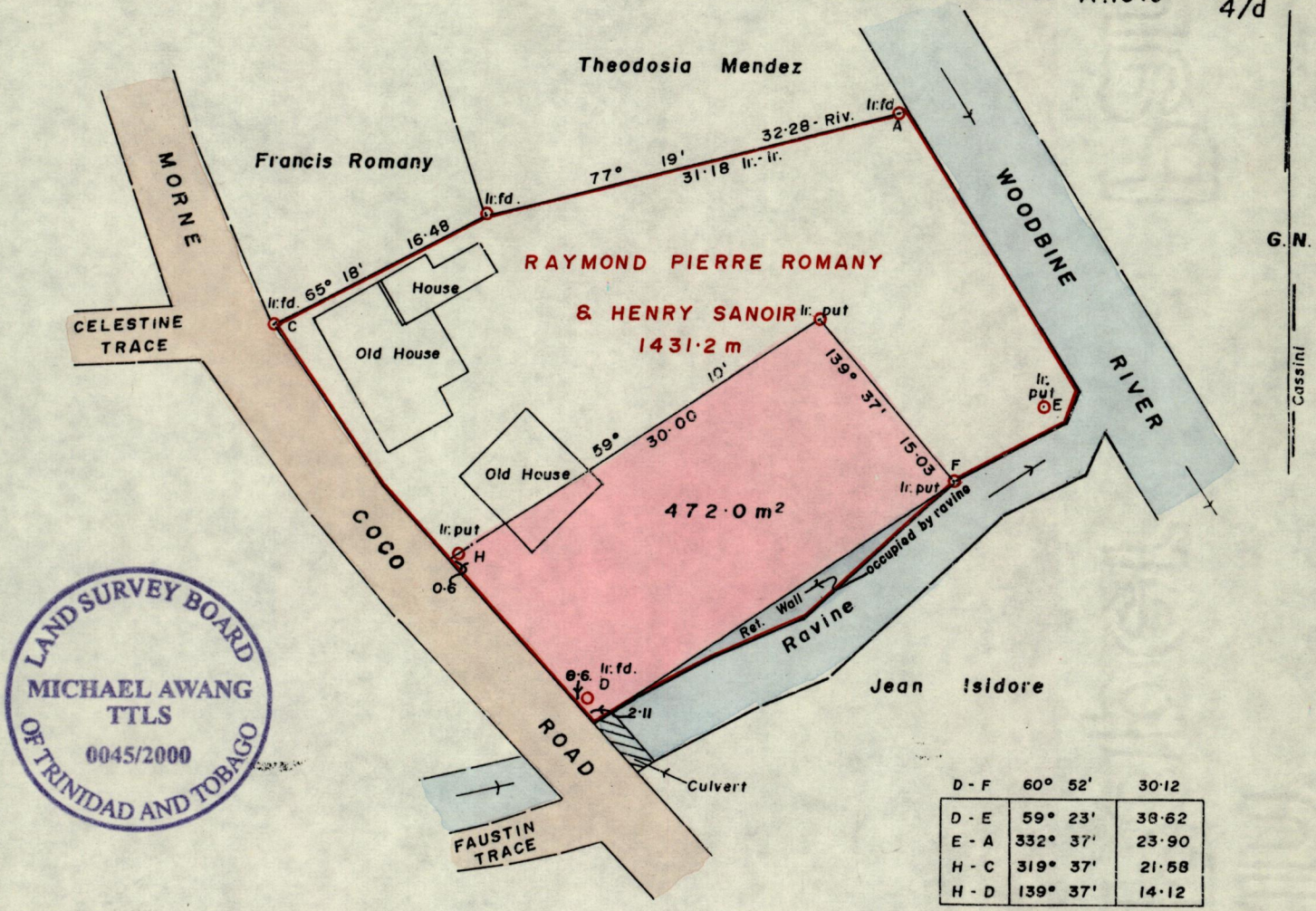

D - F	60° 52'	30.12
D - E	59° 23'	38.62
E - A	332° 37'	23.90
H - C	319° 37'	21.58
H - D	139° 37'	14.12

See BK. 1198 fol. 144

Approved *[Signature]*
Director of Surveys 2000.9.18

Bearings are based on Solar Observations
Note: To obtain compass bearings add/subtract minutes Distances are in metres

SCALE 1 / 500

PLAN of a Parcel of land coloured pink in the Ward of Diego Martin
Containing four hundred and seventy two square metres
Surveyed by me, with due authority, in October 1999

~~I certify that I have complied with rule 76 under section 14(2)(d) of the
Land Surveyors' Ordinance, 1952, and that this plan is correct.~~
In accordance with Rule 25(1) of the Land Surveyors' 1998, I certify that this plan is correct.

Checked by *[Signature]*

Entered Land Surveyor, Trinidad and Tobago *[Signature]* T.T.L.S.
23rd July, 2000.