

1249

209

REMAINING PORTION

R.P.O. Vol. 314
C.T. Vol. 1711

Fol. 569
Fol. 43

Ward of *Matura*
County of *St. Andrew*
Cadastral Sheet C. 14.F. $\frac{16B}{3/a}$

John Gilbert now Balandra Est. Ltd.

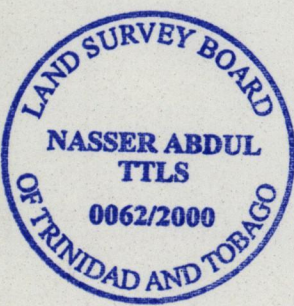
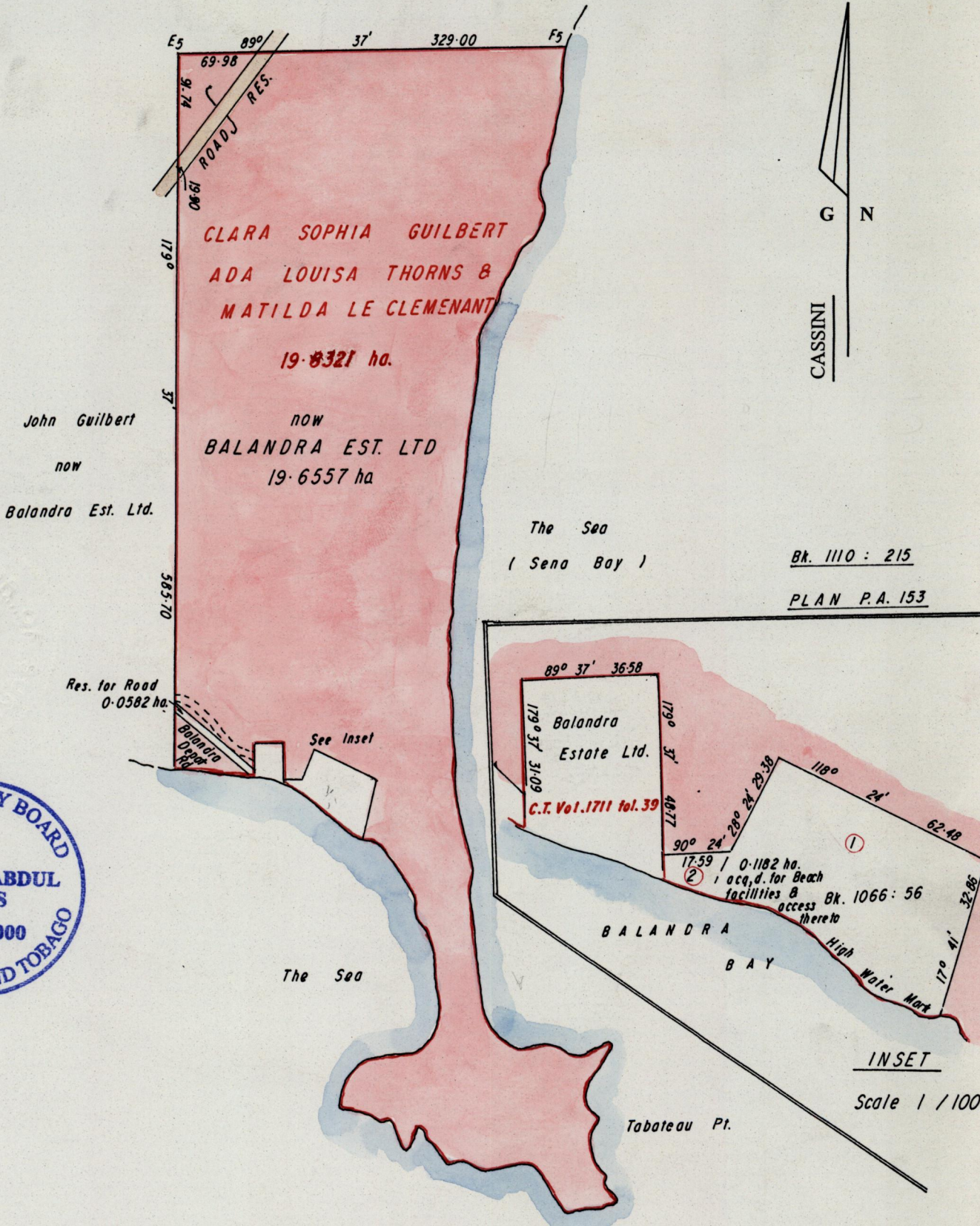

Approved

[Signature]
 Director of Surveys 2000.9.15

SCALE 1 / 5000
Distances are in METRES

Note: To Obtain compass bearings add/subtract minutes

This is a true copy of a diagram of *nineteen point eight three two one hectares* originally granted to *CLARA SOPHIA GUILBERT, ADA LOUISA THORNS & OR.*, showing a portion coloured pink and containing *nineteen point six five five seven hectares* being the remainder after (i) one resumption, (ii) one acquisition & (iii) one previous transfer of another portion of the land. In accordance with Rule 25[1] of the Land Surveyors Regulations 1998. I certify that this plan is correct.

Checked by *[Signature]*

[Signature]
 20th July

Entered Trinidad and Tobago Land Surveyor 2000