

R.P.O. Vol. 633 Fol. 231
C.T. Vol. 3877 Fol. 305

Cadastral Sheet E.6.I. $\frac{35.F}{17a}$
Ward of Tamana
County of St. Andrew
Vide: Bk. 584 Fol. 196

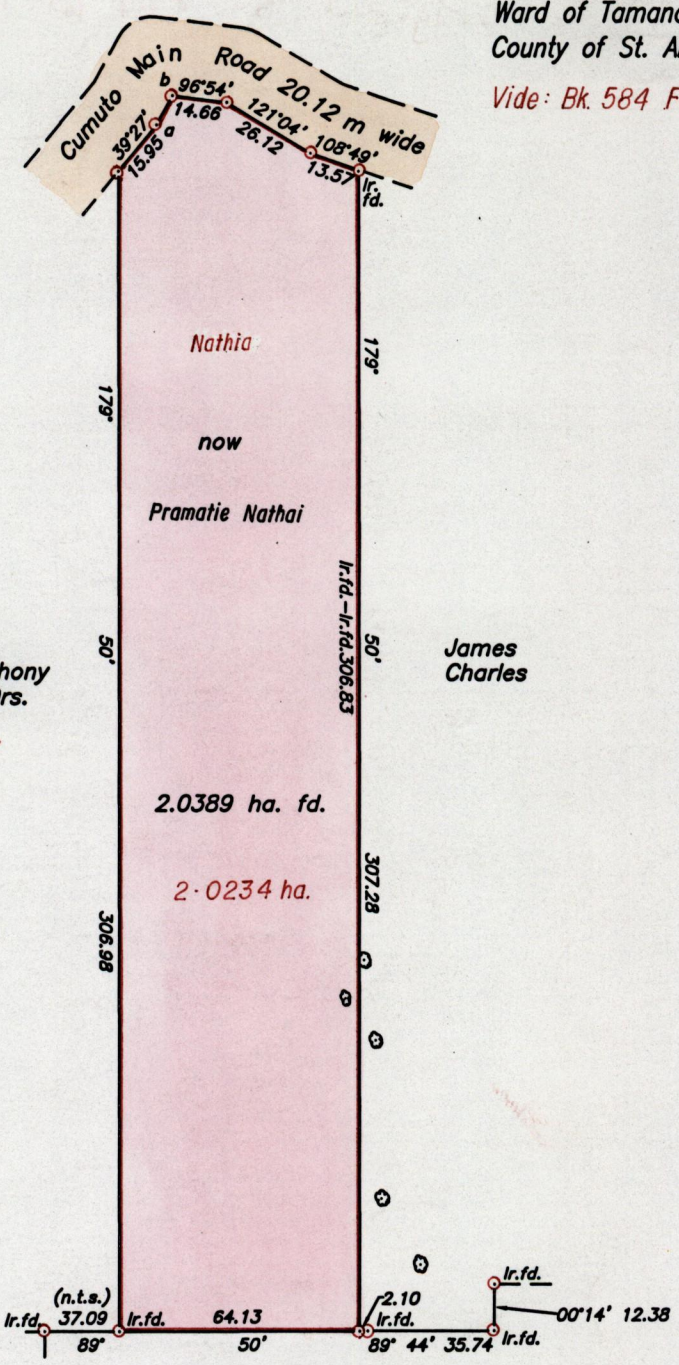

Mahabir then
Soomaria Anthony
Mahabir & Ors.
BK. 1148 FOL. 117

James Charles

Martin Sasa then
Paul Guiseppi & Adela Guiseppi

Approved. *[Signature]*
Director of Surveys of
Trinidad & Tobago

a - b 28° 40' 8.86
SCALE 1:2000
Distances are in Metres

- ⊗ Denotes Tree
 - Denotes Iron put except otherwise stated.
- Bearings are based on solar observations

Plan of a Parcel of Land coloured pink in the Ward of Tamana
Containing two point zero three eight nine hectares
Surveyed by me, with due authority in April 5th. 2000

I certify that this plan is correct, in accordance with Rule 25 (1) of the
Land Surveyors' Regulations 1998.

Checked by *[Signature]*

[Signature]

Entered. Land Surveyor, Trinidad & Tobago. 26/04/2000

GANESH DATH RAMCHARITAR
LAND SURVEYOR

