

1249

1483

R.P.O. Vol. 690 fol. 81  
C.T. Vol. fol.

Cadastral Sheet 55 A D. 25.L.  
1/4 B 2/c  
Ward of Charuma  
County of Nariva

Vide Bk. 632:63  
& S.O. 243/29

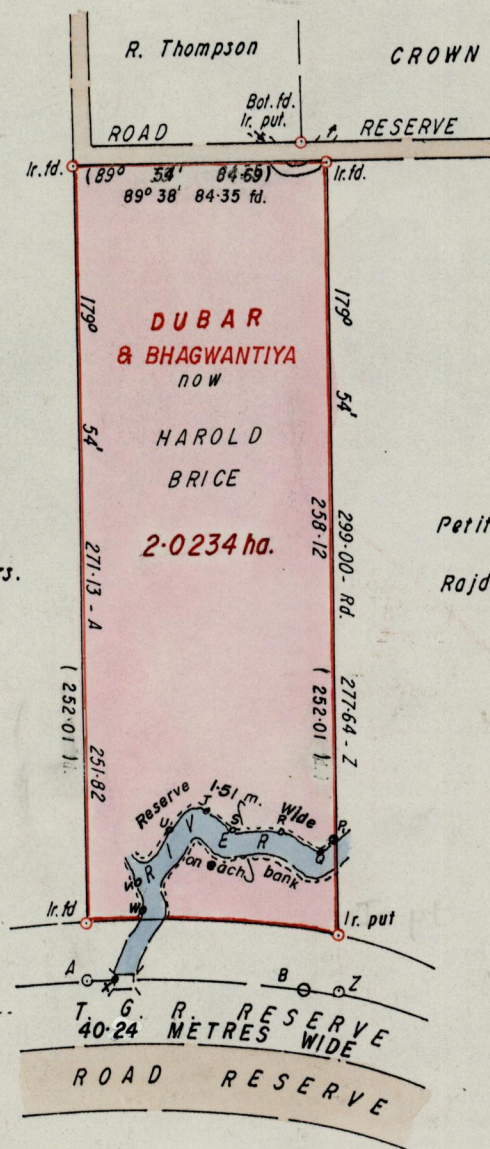

Pirithi Lal & Ors.

Petitioned for by  
Rajdai Siuratan

LEGEND

STATION	BEARING	DISTANCE
Z - P <sub>1</sub>	359° 54'	48.66
P <sub>1</sub> - Q	245° 50'	7.64
Q - R	303° 20'	13.44
R - S	271° 39'	15.37
S - T	307° 23'	14.81
T - U	265° 54'	10.08
U - V	217° 51'	25.71
V - W	161° 55'	11.27
W - X	199° 51'	26.31
A - X	91° 54'	8.01
A - B	91° 54'	64.23
B - Z	100° 51'	20.61

Bot. fd. Ir. put. - Ir. fd. 127° 44' 9.04

Approved *[Signature]*  
Director of Surveys  
2000.7.12

Scale 1 / 2500  
Distances are in metres

Bearings are based on Solar Obs.

PLAN of a parcel of land coloured pink in the Ward of Charuma  
Containing two point zero two three four hectares

Surveyed by me with due authority in May 1998

I certify that I have complied with rule 76 under section 14(2)(d) of the Land  
Surveyors' Ordinance 1952 and that this plan is correct.

Checked by *[Signature]* 05.25

Entered .....

G.P., Tr./To.-943-20,000-183

*Murchison Pierre*  
Land Surveyor, Trinidad 30<sup>th</sup> June 1998

