

1249

REMAINING PORTION

147

R.P.O. Vol. 200 Fol. 229
C.T. Vol. Fol.
U.P.R.N. No.

Ward of *Montserrat*
County of *Caroni*
Cadastral Sheet D.25.K, 1/d ^{55A}
Bk. 1189 : 1, Bk. 1005: 191, 964: 203

C.T. Vol. 1615 Fol. 347

The Incorporated Trustees
of the Church of England
in Trinidad and Tobago
746.1m²

Emanuel
Thompson

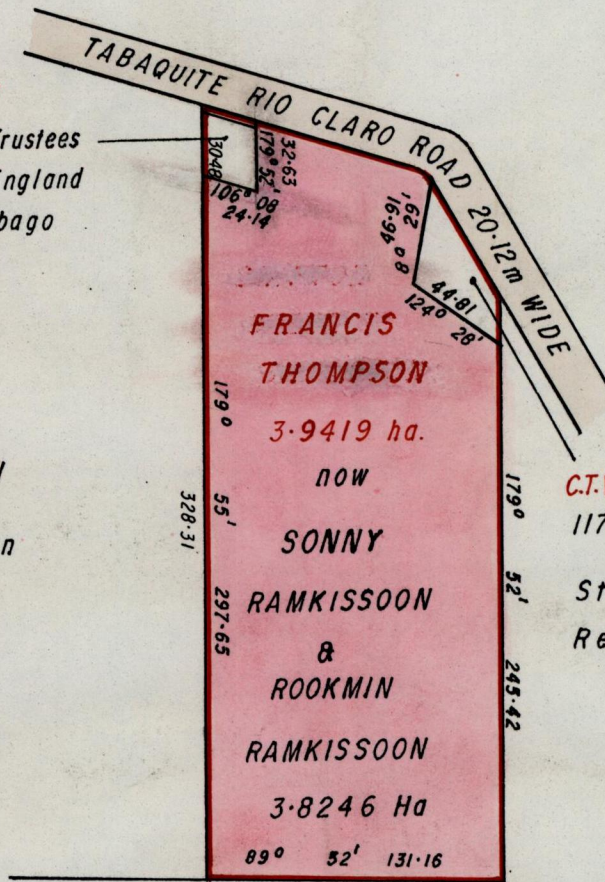

C.T. Vol. 3285 fol. 267

1173.0m²
State Reserve

State then E. Thompson

Cassini
G.N.

Approved by

[Signature]

Director of Surveys
2010.7.12

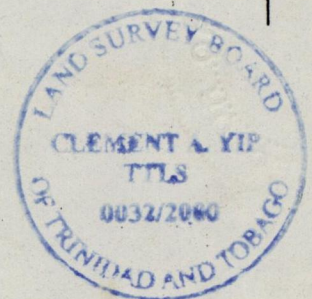

SCALE:- 4 Chains
Distances are in metres

Note: To obtain compass bearings add/ subtract 8 minutes

This is a true copy of a diagram of three point nine four one nine hectares originally transferred to SONNY RAMKISSOON & ROOKMIN RAMKISSOON shewing a portion coloured pink and containing three point eight two four six hectares being the remainder after two previous transfers of another portion of land

In accordance with Rule 25 (1) of the Land Surveyors' Regulations 1998, I certify that this plan is correct.

Checked by *[Signature]*

Entered on.....

[Signature]

Trinidad & Tobago Land Surveyor..... 8/5/00