

R.P.O. Vol. 125

Fol. 675

Cadastral Sheet G.12.G.

C. of T. Vol.

Vol.

Ward of Siparia

County of St. Patrick

SEE BK. 1137 fol. 36

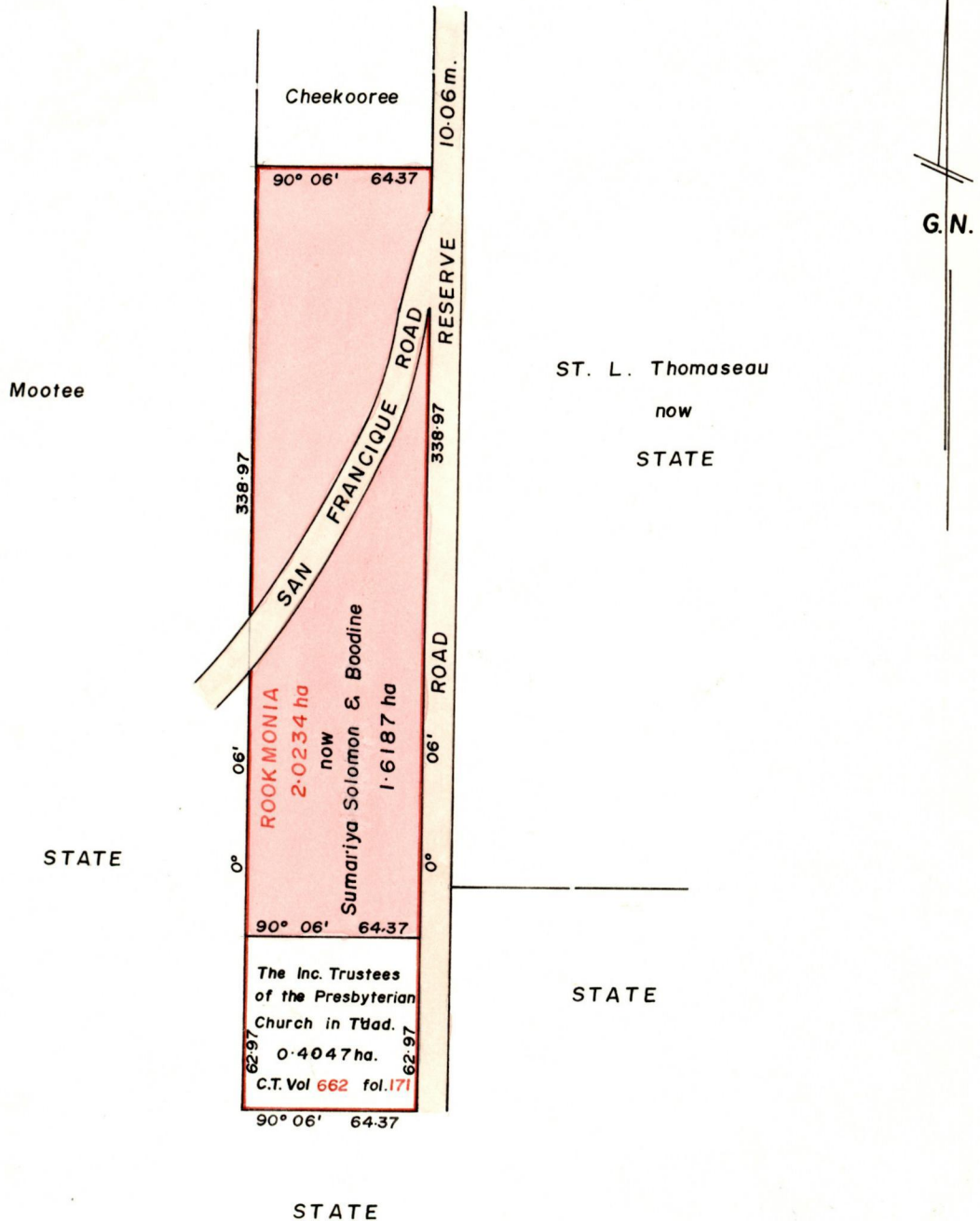

Approved

*[Signature]*  
 Director of Surveys  
 99.3.11

SCALE 1: 2500

Note: To obtain compass bearings ~~add~~ 6 minutes subtract

Distances are in metres

This is a true copy of a diagram of **Two point zero two three four hectares** originally granted to **ROOKMONIA**, shewing a portion coloured pink and containing **one point six one eight seven hectares** being the remainder after **one** previous transfer of another portion of the land, the dividing lines having been run in conformity with Rule 76 under Sec. 7(d) of Cap. 27. No. 2 and duly certified by the Director of Surveys.

Checked by *[Signature]* 99.03.08

Entered on

*[Signature]*  
 Land Surveyor, Trinidad, *24* December 19*98*

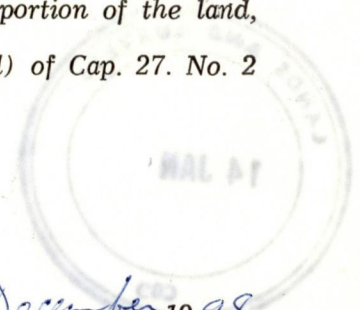

Original Bk 1137 fol. 36

