

NOS.	AREAS	NAMES	CT. Vol.	Fol.
6	475.4 m <sup>2</sup>	Kenneth Dean	1857	229
7	475.4 m <sup>2</sup>	Lakhan Koosial & Shirley Koosial	2663	263
8	475.4 m <sup>2</sup>	Gajadhar Sadama	1916	459
9	475.4 m <sup>2</sup>	Bernard Jaipaul & Alescia Jaipaul	1857	253
10	475.4 m <sup>2</sup>	Clifton Julien	1857	241
11	475.4 m <sup>2</sup>	Estellita Birch & Rosa Birch	1916	471
12	475.4 m <sup>2</sup>	Angela Dhanraj	2663	279
13	475.4 m <sup>2</sup>	Eugenia Bobb	1857	235
14	475.4 m <sup>2</sup>	Conrod Rauceo & Elizabeth Rauceo.	1857	247
15	475.4 m <sup>2</sup>	Suresh Balkaran & Polly Balkaran	2663	271
16	475.4 m <sup>2</sup>	Germin Jones	1916	465

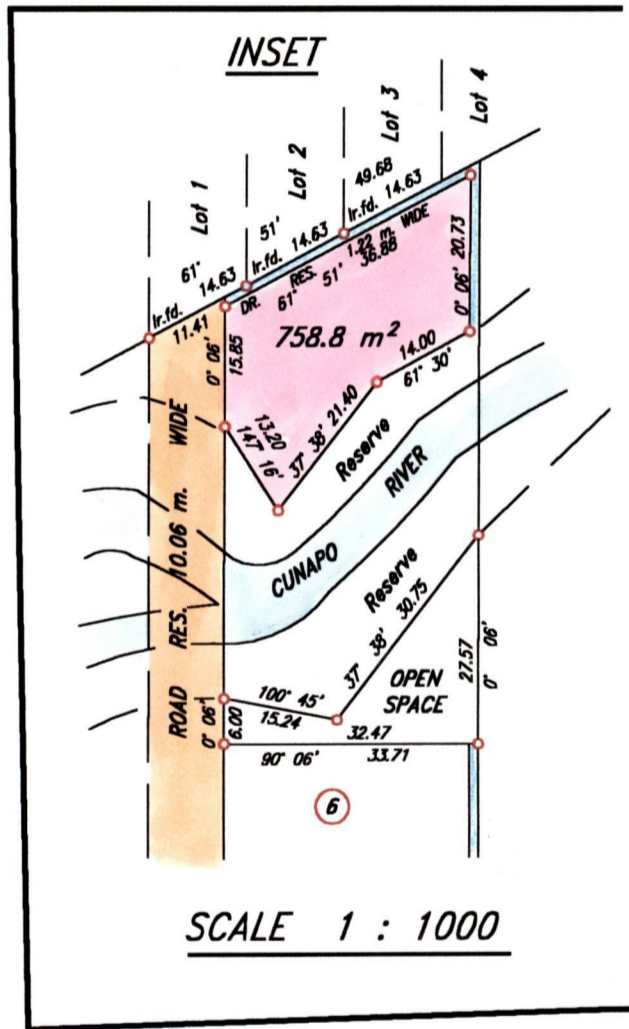

Approved *[Signature]*  
Director of surveys

SCALE 1 : 2500

Bearings are based on Solar Observations  
Note: To obtain compass bearing subtract 06 minutes Distances are in metres  
PLAN of a Parcel of land coloured pink in the Ward of Siparia  
Containing seven hundred and fifty eight point eight sq. metres.  
Surveyed by me, with due authority, in February 1995.  
I certify that I have complied with rule 76 under section 14(2)(d) of the  
Land Surveyors' Ordinance 1952, and that this plan is correct.

Checked by *[Signature]*  
Entered..... Land Surveyor, Trinidad and Tobago..... 21st March 1995

○ Denotes Iron put, except otherwise stated.

Original Plan P.E. 72

