

Cadastral Sheet B.24.C., 24B
Borough of Arima
County of St. George

Bk. 05 : 222

R.P.O. Vol. 46 Fol. 675
Regrant in R.P.O. Vol. 372 Fol. 369

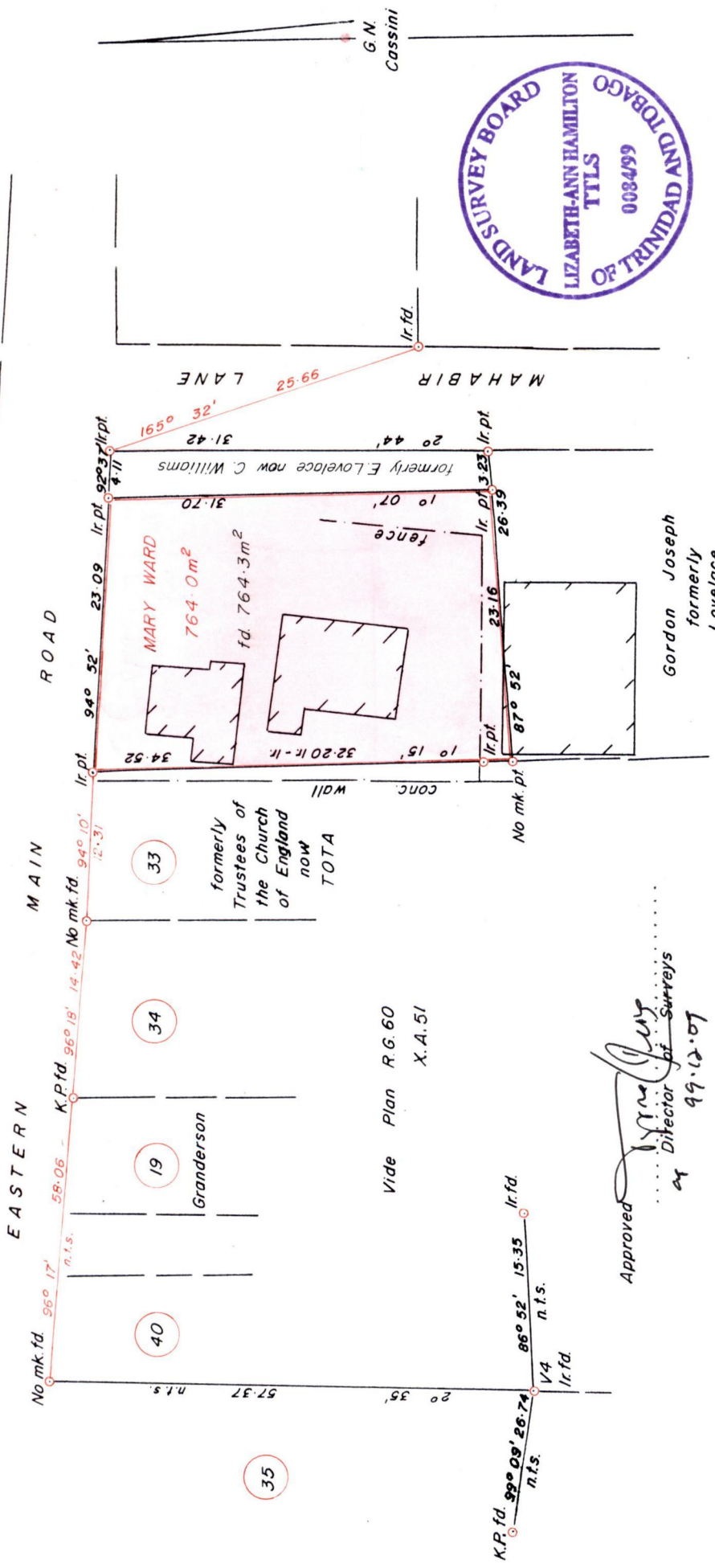

Scale 1:500
Distances are in metres
Bearings are Cassini based on Solar Obs.
To obtain compass bearings add 8'

PLAN of a Parcel of land coloured pink in the Borough of Arima
Containing seven hundred and sixty four point three square metres
Surveyed by me, with due authority, on the 27th February 1999 for Carran Williams

In accordance with Rule 25(1) of the Land Surveyors' Regulations 1998, I certify that this plan is correct.

Approved
Lizbeth Ann Hamilton
Director of Surveys
99.02.07

Checked by *MC991013*
Ent. on

Lizbeth Ann Hamilton
Trinidad & Tobago Land Surveyor
March 19, 1999