

Ward of Siparia.

County of St.Patrick.

Cadastral Sheet G.12.J. 63D
4/b

R.P.O. Vol. 126

Fol. 639

C.T. Vol. 3772

Fol. 149

Original Survey Bk.466 fol.85
See Plan F.A.120

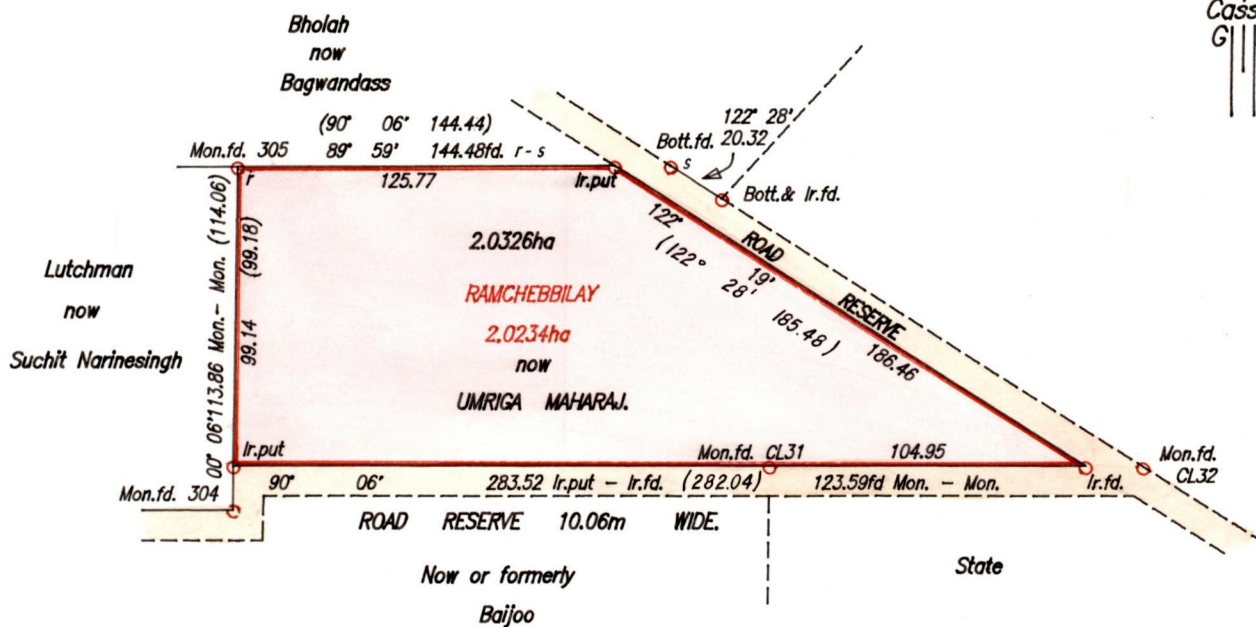

Approved

[Signature]
Director of Surveys
99.10.20

Note : To obtain compass bearings subtract 6 minutes.

Bearings are based on Solar Observations

PLAN of a Parcel of land coloured pink in the Ward of Siparia.

Containing two point zero three two six hectares.

Redefined by me, with due authority, in May,1998.

I certify that I have complied with rule 76 under section 14(2)(d) of the Land Surveyor's Ordinance 1952, and that this plan is correct.

Checked by *[Signature]* 99/10/06

Entered Land Surveyor, Trinidad & Tobago. *[Signature]* 1998 .

SCALE 1:2500
Distances are in Metres

