

Ward of Siparia
 County of St. Patrick
 Cadastral Sheet G.18.H. 13C
 2/d

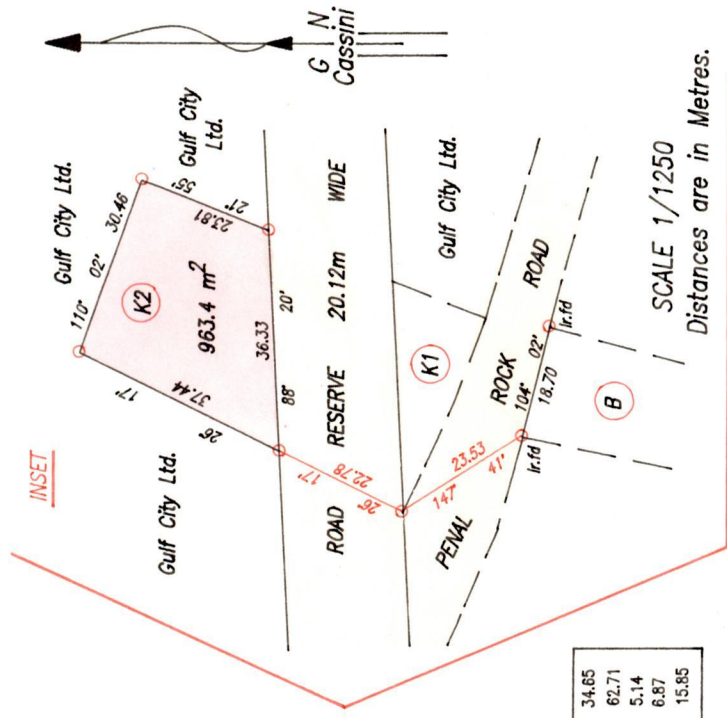

SCALE 1/1250
 Distances are in Metres.

R.P.O. Vol. 152
 C.T. Vol. 2471

Vide Plan P.A.192
 G.A.131

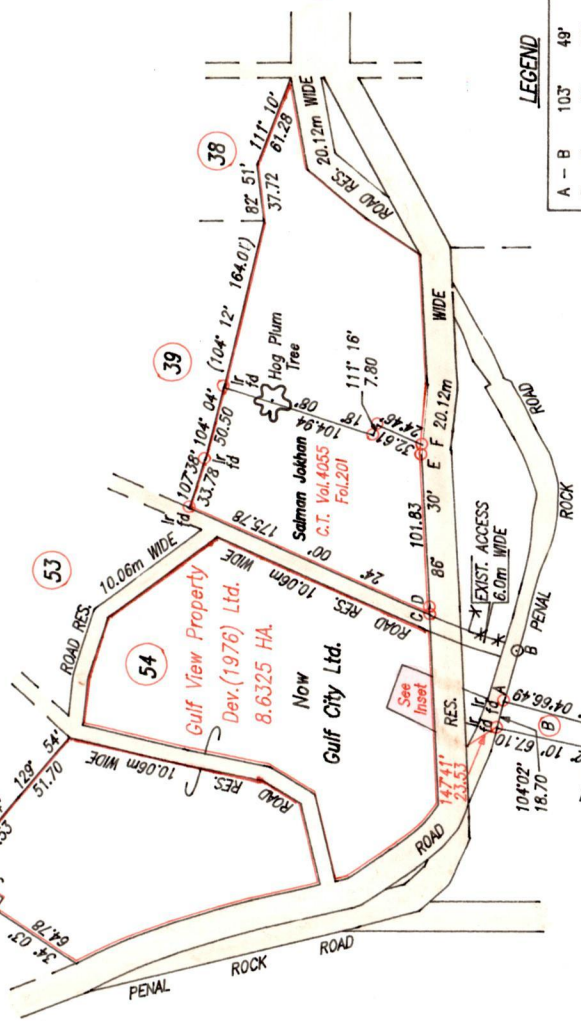

LEGEND

A - B	103°	49'	34.65
B - C	22°	25'	62.71
C - D	87°	02'	5.14
E - F	94°	50'	6.87
G - H	101°	57'	15.85

SCALE 1/5000
 Distances are in Metres.

Approved *[Signature]*
 Director of Surveys 99-9-22

Denotes Iron put except otherwise stated
 Bearings are based on solar Observations

PLAN of a Parcel of land coloured pink in the Ward of Siparia
 Containing nine hundred and sixty three point four square metres
 Surveyed by me, with due authority, in November 1997 & February 1998

I certify that I have complied with rule 76 under section 14(2)(d) of the Land Surveyor's Ordinance 1952, and that this plan is correct.

Checked by: *[Signature]* 99/107/19

Entered
 Land Surveyor, Trinidad & Tobago. 15/03/1999.
 PATH = 386 C:\GULFCITY\S-CHUNILDING

original survey plan P.A. 192

