

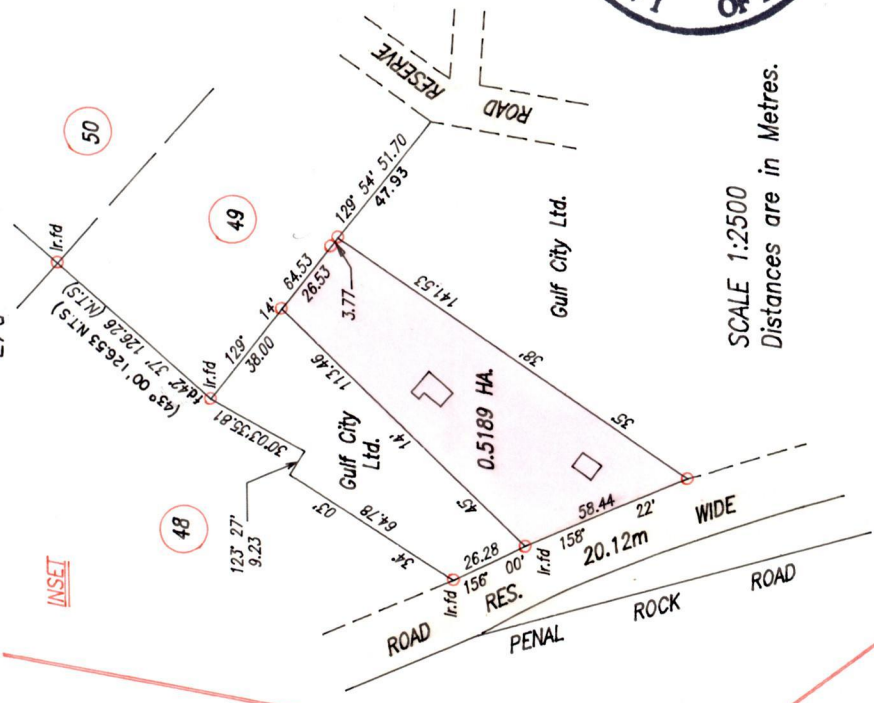

Ward of Siparia
County of St. Patrick
Cadastral Sheet G.18.H. 73C
2/d

Fol. 241
Fol. 179

R.P.O. Vol. 152
C.T. Vol. 2471

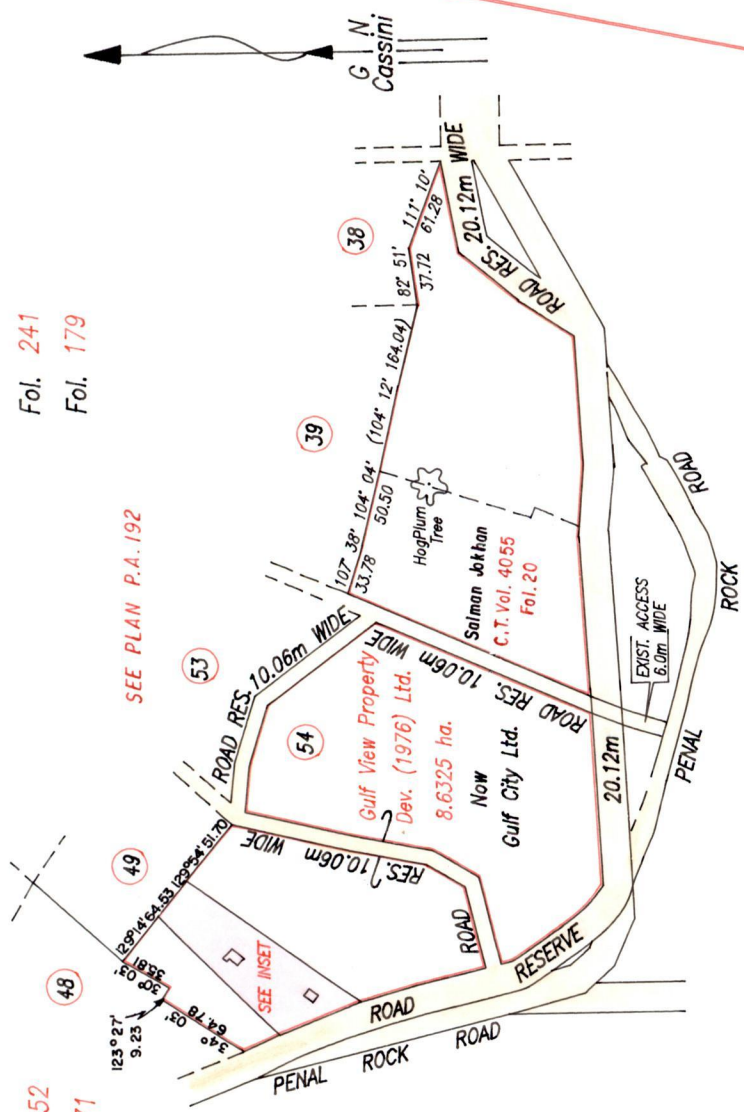

SCALE 1:5000
Distances are in Metres.

SCALE 1:2500
Distances are in Metres.

Approved
Yvonne Dwyer
Director of Surveys
99-7-2

o Denotes Iron put except where otherwise stated
Bearings are based on solar Observations

PLAN of a Parcel of land coloured pink in the Ward of Siparia
Containing zero point five one eight nine hectare
Surveyed by me, with due authority, on 28th July 1998

I certify that I have complied with rule 76 under section 14(2)(d) of the Land Surveyor's Ordinance 1952, and that this plan is correct.

Checked by *A.P. 99/06/29*

Entered
Trinidad & Tobago, Land Surveyor . 15/03/1999
PATH = 386 C:\GULFCITY\SKELLY.DWG

Original Plan P.A. 192

