

A N^o 0362

Cadastral Sheet $\frac{12C}{47b/3}$ (A. 14. G.)

Ward of Diego Martin

CT. Vol. 1334 Fol. 325

County of St. George

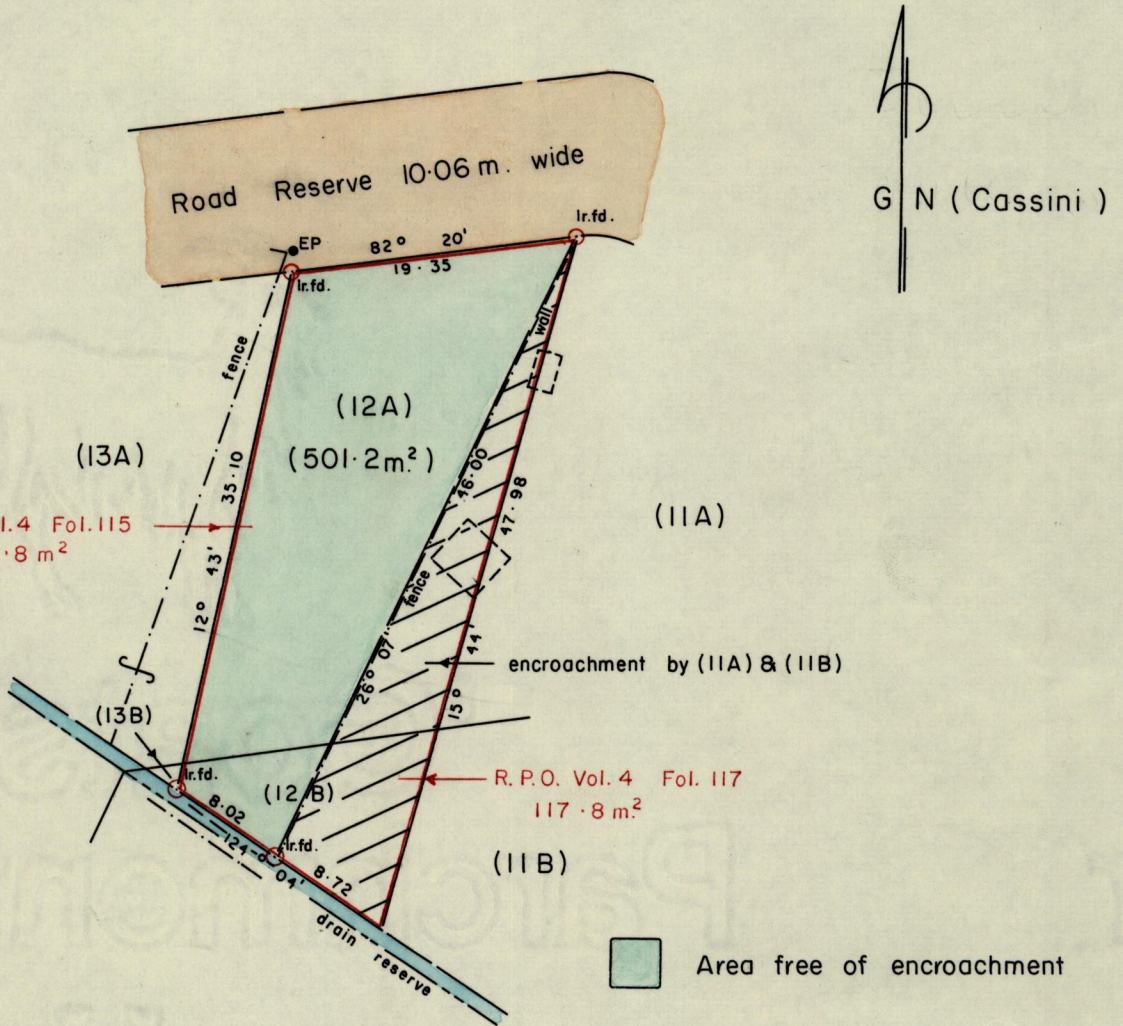

See Plan E.H. 87.

Bearings are based on Irons found.
add

SCALE 1 : 500

Note: To obtain compass bearing subtract 2 minutes Distances are in METRES
PLAN of ~~a~~ Parcel of land, ~~coloured~~ bordered red in the Ward of Diego Martin
Showing the area free of encroachment coloured green as 501.2 m².

Surveyed by me, with due authority, in September 1998 for at the request of
First Citizens Bank Limited

NOTED ON PLAN E.H.87

3/2/99 S.H.B.

ENTERING CHECKED BY

9928

Paul Williams

Land Surveyor, Trinidad and Tobago.....*Sept 08 1998*