

40
#10-50

1236

45

L. and S.—53

A N^o 0036

Cadastral Sheet $\frac{24 A}{2/c}$ (B.18.0)

Ward of Tacarigua

County of St. George

R.P.O Vol. 100 Fol. 201
C.T Vol. 2207 Fol. 47

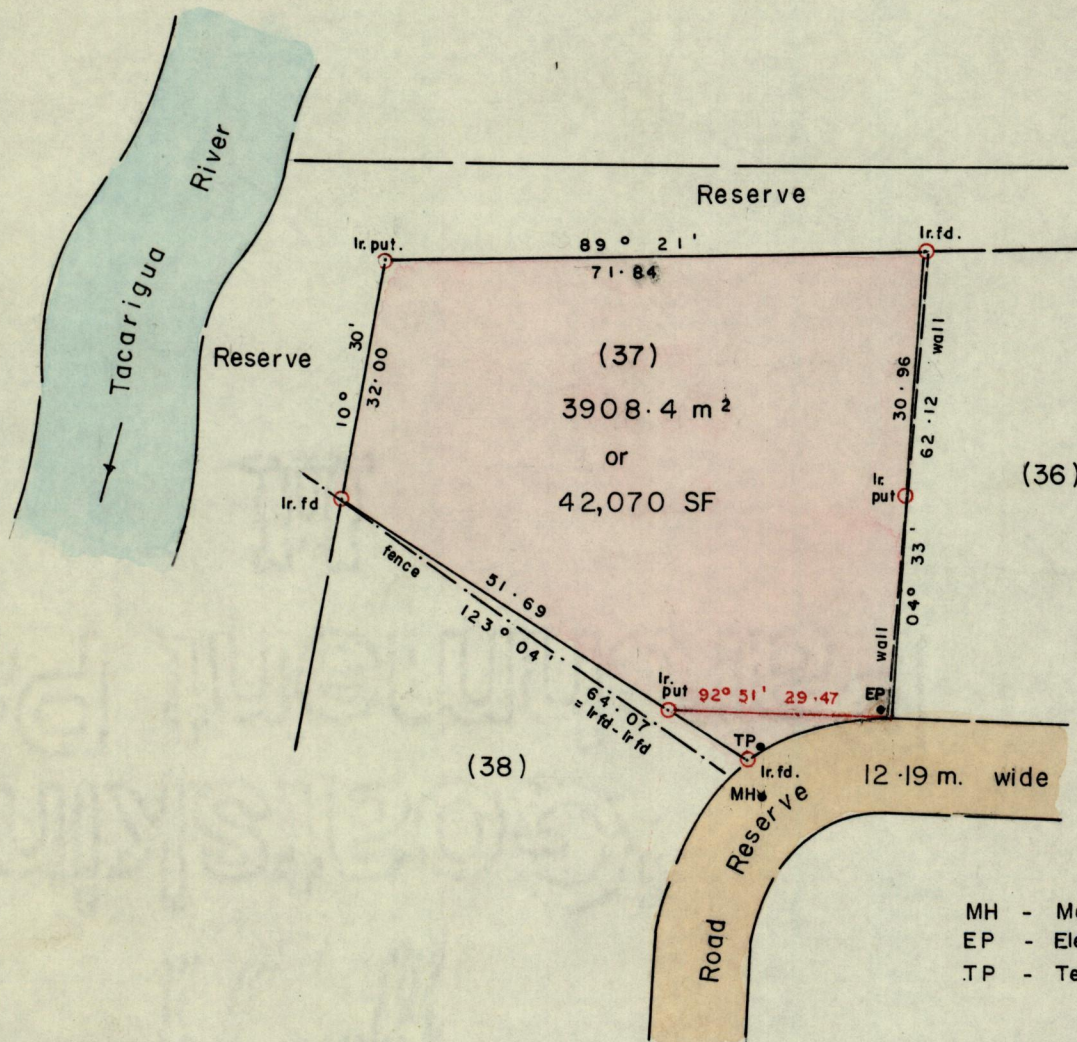
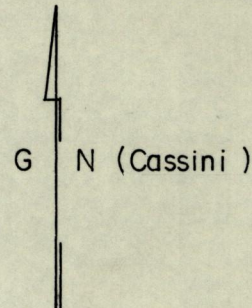

MH - Man hole
EP - Electricity Pole
TP - Telephone Pole

Bearings are based on solar observations

SCALE 1 : 1000

add

Note: To obtain compass bearing subtract minutes Distances are in METRES

PLAN of a Parcel of land coloured pink in the Ward of Tacarigua

Containing three thousand nine hundred and eight point four square metres

Redefined Surveyed by me, with due authority, in April 1997 for J & G Holdings Limited

Ent. on $\frac{24A}{1/c}$ BC.

Ent. Checked by Paul Williams

Land Surveyor, Trinidad and Tobago.....April 30.....19.97.

G.P., TR./To.—M 2654—2,000—1/97

Recvd 98.3.5