

1236

R.P.O.Vol. 565
C.T.Vol. 1732

Fol. 233
Fol. 281

Ward of Charuma
County of Nariva
Cadastral Sheet 45E/3/d(E.21.B.)

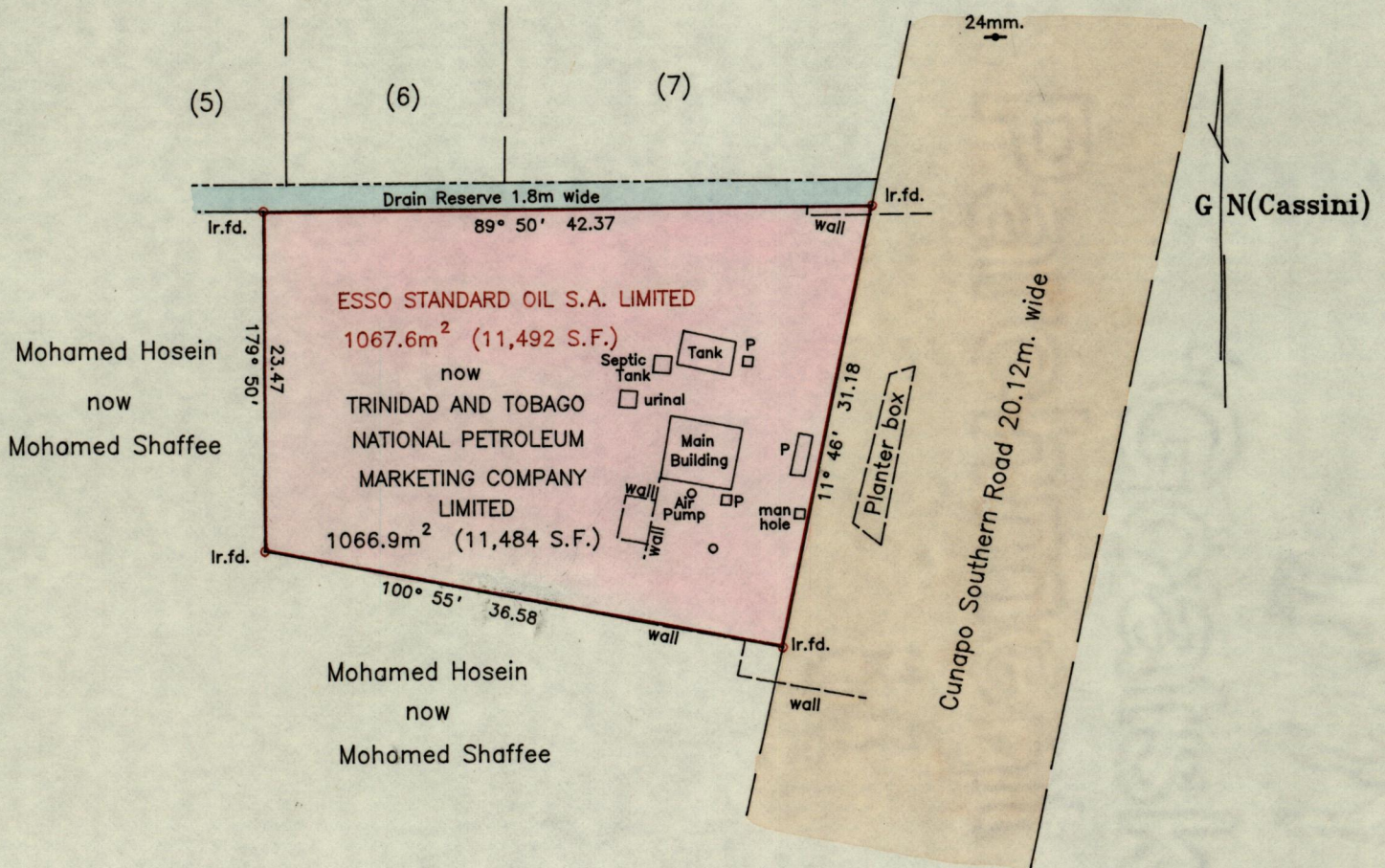

P - Pump
E - 24mm. 36° 33' 14.37

Original Survey see BK. 1233 Fol.142

Approved.....
Director of Surveys.

Reference
Plan B.E.17

SCALE 1 : 500

Distances are in METRES.

Note: To obtain compass bearings add 10 minutes.

Plan of a parcel of land coloured pink in the Ward of Charuma
Containing one thousand and sixty- six point nine square metres
Surveyed by me, with due authority, in March 1989

I certify that I have complied with rule 76 under section 14(2)(d) of the
Land Surveyors' Ordinance 1952, and that this plan is correct.

Checked by..... *Paul Williams*.....

Noted on... 45E
3/d.....

Land Surveyor, Trinidad..... 10/4/.....1989.

97/09/26

Y.B.

97-9-26