

No 48404

R.P.O. Vol. 99  
C.T. Vol. 1134

Fol. 271  
Fol. 251

Ward of St. Anns  
County of St. George  
Cadastral Sheet 13E (A.20.C.)  
1/c

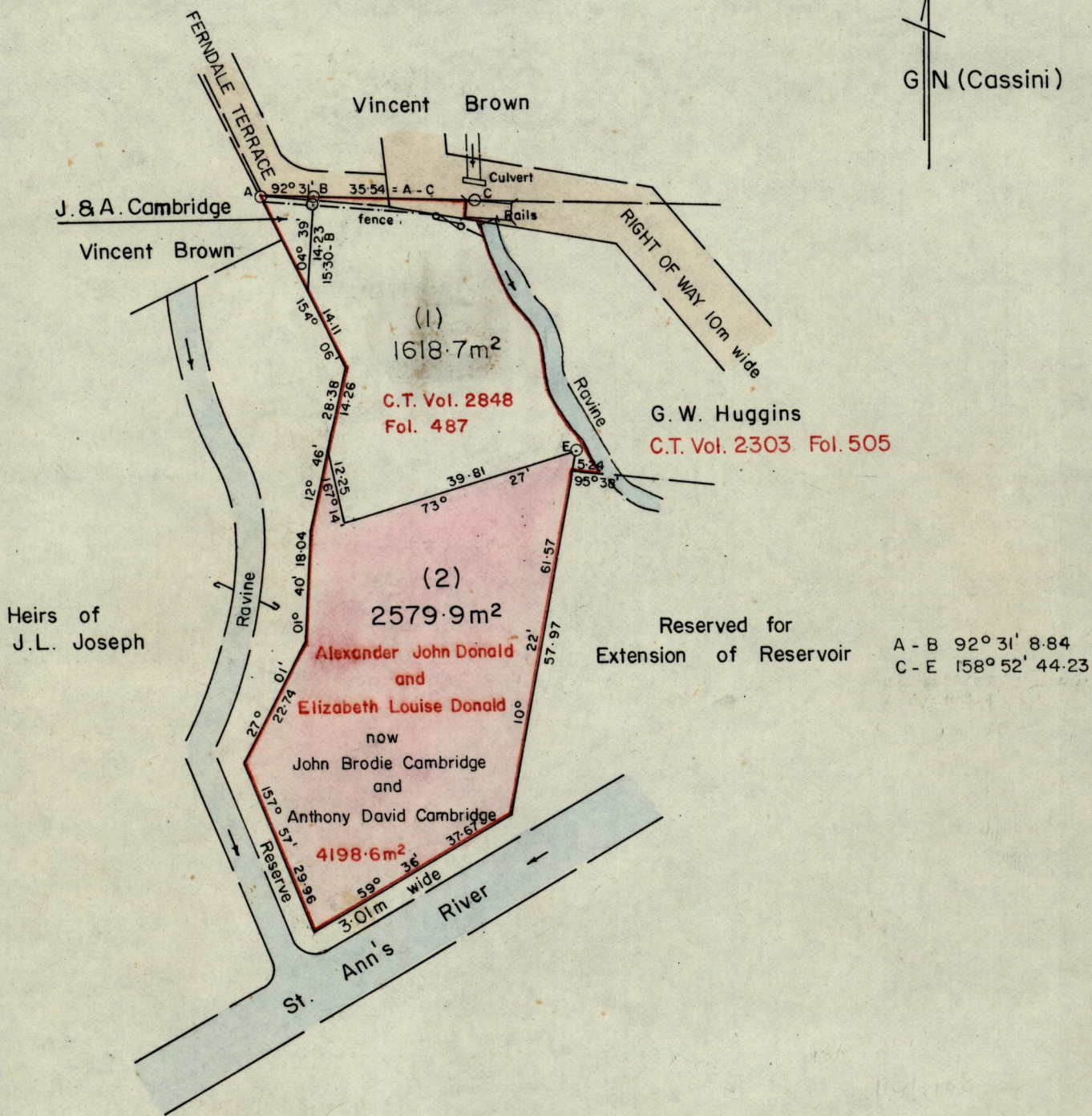
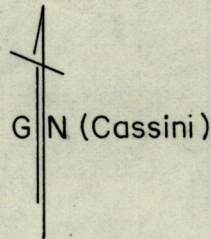

Approved

Director of Surveys

Previous Survey see BK. 1141 Fol. 108

SCALE 1:1000

Note: To obtain compass bearings subtract 1 minute. Distances are in METRES

PLAN of a Parcel of land coloured pink in the Ward of St. Anns

Containing two thousand five hundred and seventy-nine point nine square metres.

Compiled from previous surveys by J. Reece in June 1948 and A. Aquí in March 1978. for Cambridge

I certify that I have complied with rule 76 under Section 14 (2) (d) of the Land Surveyors' Ordinance 1952, and that this plan is correct.

Checked by .....

Entered .....

Land Surveyor, Trinidad 27 March 1984

NOTED ON 13E  
97/07/30 1/c