

1236

1213

R.P.O. Vol. 75 Fol. 55

24C
Cadastral Sheet 1/b4(B.19.P.)

Borough of Arima

County of St. George

R.D. 16826/1975

113

REDEFINITION SURVEY

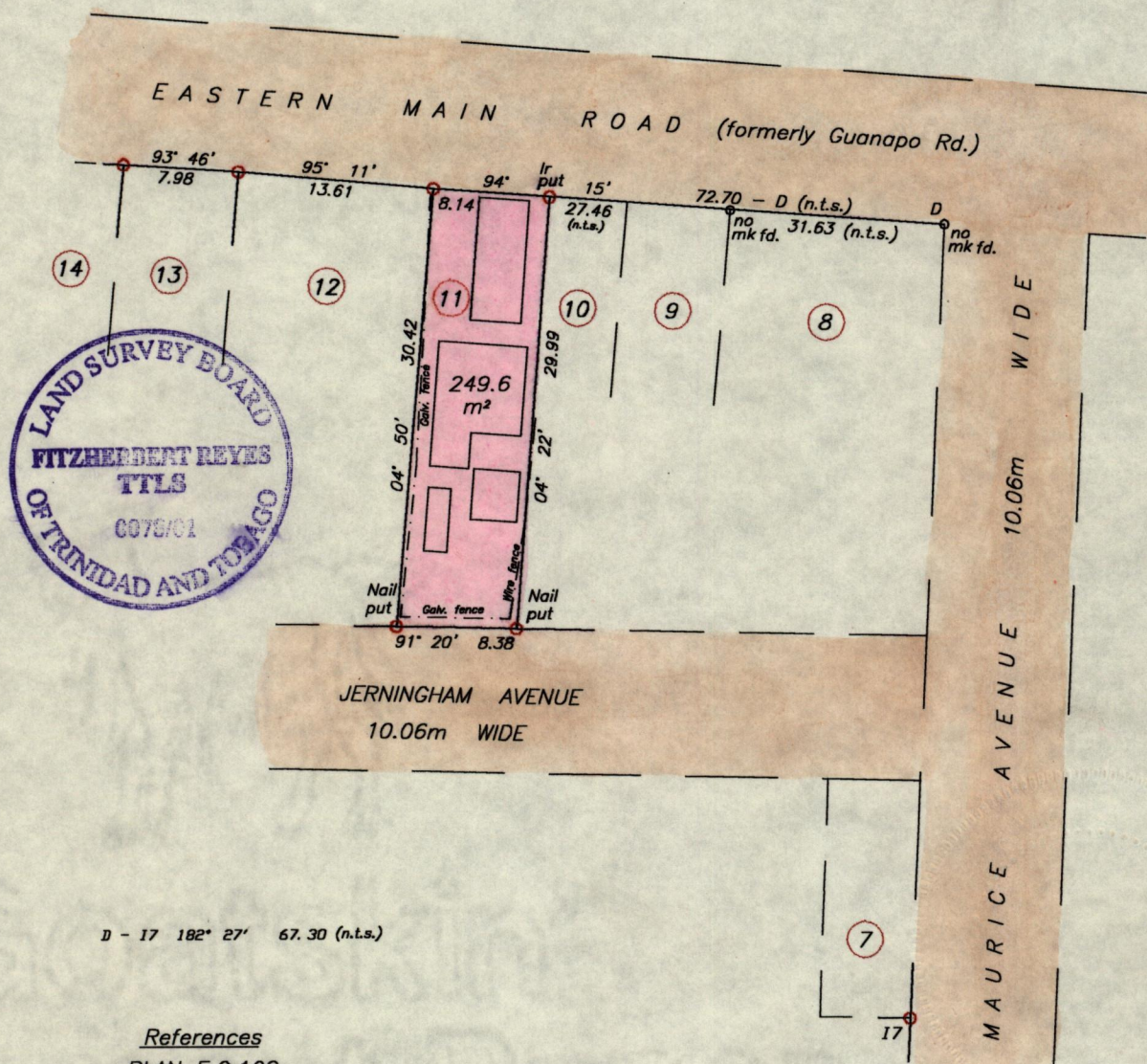

D - 17 182° 27' 67.30 (n.t.s.)

References
PLAN E.G.108
Bk.1179 Fol.3

SCALE 1:500
Distances are in METRES

⊙ Denotes Iron found unless otherwise stated
Bearings are Cassini Grid and based on Solar observations

PLAN of a Parcel of land coloured pink in the Borough of Arima
Containing two hundred and forty nine point six square metres
Surveyed by me, with due authority, in February 2001 for Claristus Le Blanc
In accordance with Rule 25 (1) of the Land Surveyors' Regulations 1998,
I certify that this Plan is correct.

ENTERED ON 11/6/01
JD'S 29/01/03

D.A. Reyes

Trinidad and Tobago Land Surveyor
22 February 2001
2001.03.03