

106

1236

Ward of Naparima
County of Victoria
Cadastral Sheet (G.3.F) 53.F.
1/c/2

118

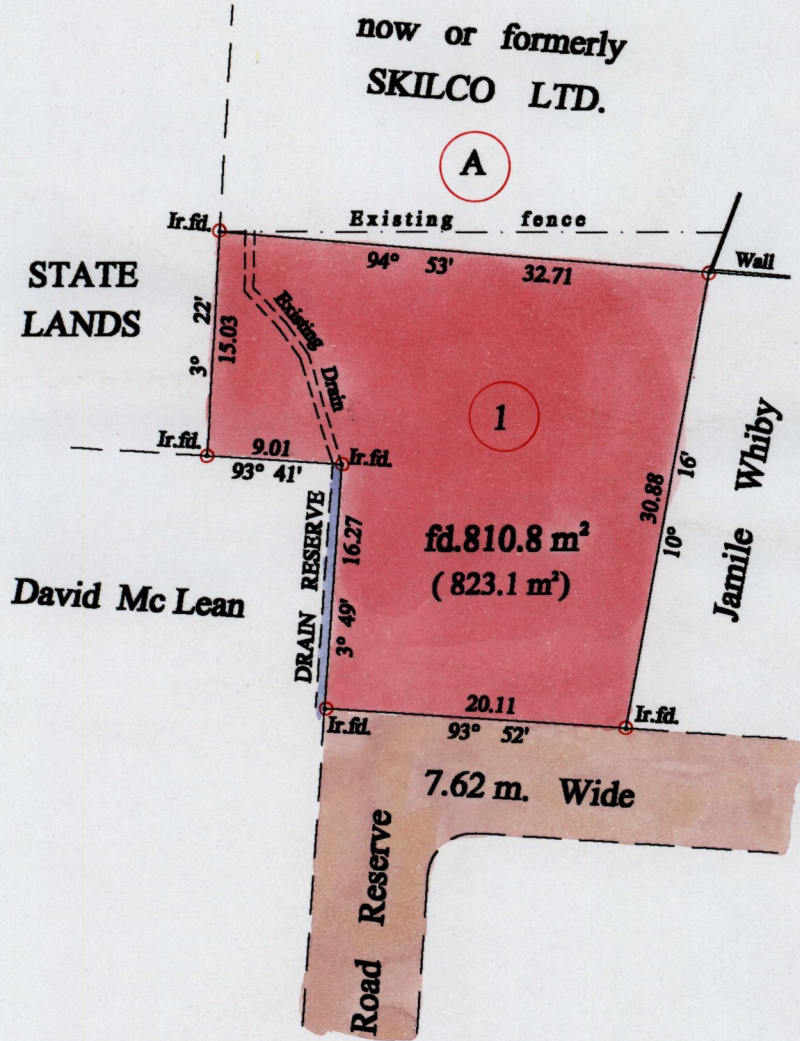

Vide Bk. 1218 fol. 67

○ Denotes Iron put except stated otherwise.

SCALE : 1:500

Note: Bearings are cassini grid based on solar observations

Distances are in metres

PLAN of a Parcel of land coloured pink in the Ward of Naparima

Containing eight hundred and ten point eight square metres

Re-defined by me, with due authority, in January 2001 for Mr. Frank Raghunanan Singh

In accordance with Rule 25 (1) of the Land Surveyors Regulations 1998,

I certify that this plan is correct.

Smt. 53F1C2MB
Com. 10/02

Trinidad & Tobago Land Surveyor 2001

2001.02.01

