

REMAINING PORTION

R.P.O. Vol. Fol.
C. of T. Vol. 1677 Vol. 285

1136

Cadastral Sheet G. 12. H. 63.E.
Ward of Siparia 2/c.
County of St. Patrick.

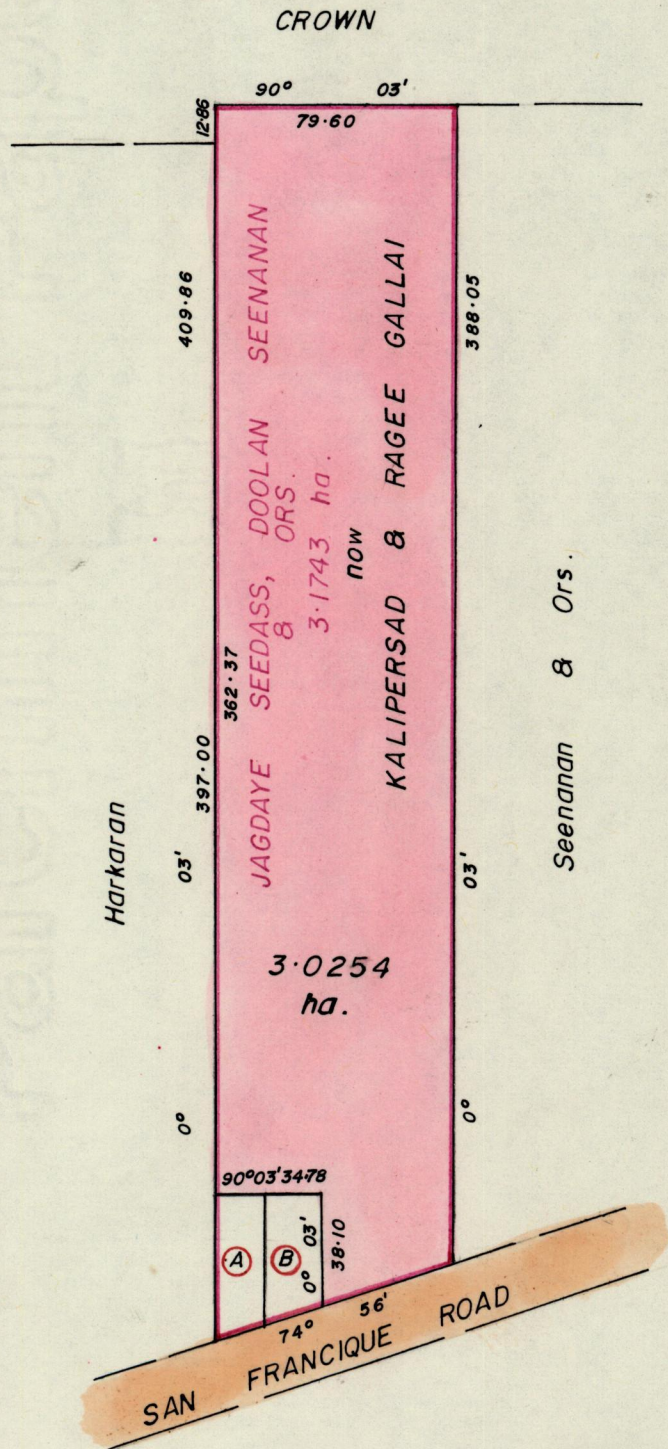

Lot#	Area	Names	C.T. Vol.	Fol.
A	746.1m ²	Ramsunair Jogie &	3220	221
B	742.5m ²	Sushella Sumariya Jogie	3377	19

G N
Cassini

Approved

Louis Charles
Director of Surveys
9/1/23

SCALE 1 : 2500

Note: To obtain compass bearings ~~with~~ subtract 3 minutes

Distances are in metres.

This is a true copy of a diagram of three point one seven four three hectares originally granted to Jagdaye Seedass, Doolan Seenanan & Ors., shewing a portion coloured pink and containing three point zero two five four hectares being the remainder after two (2) previous transfers of other portions of the land. the dividing lines having been run in conformity with Rule 76 under Sec. 7(d) of Cap. 27. No. 2 and duly certified by the Director of Surveys.

Checked by *G. R. Chatterjee*
21/1/21

Entered on

Calliecharan
Land Surveyor, Trinidad,

1/7/1921

BK. 976 - Calipersad.