

1196
1196

331

R.P.O. Vol. 216
C.T. Vol. 3482

Fol. 643
Fol. 43

Ward of Savana Grande.
County of Victoria.
Cadastral Sheet G.14.D. 64F
1/a

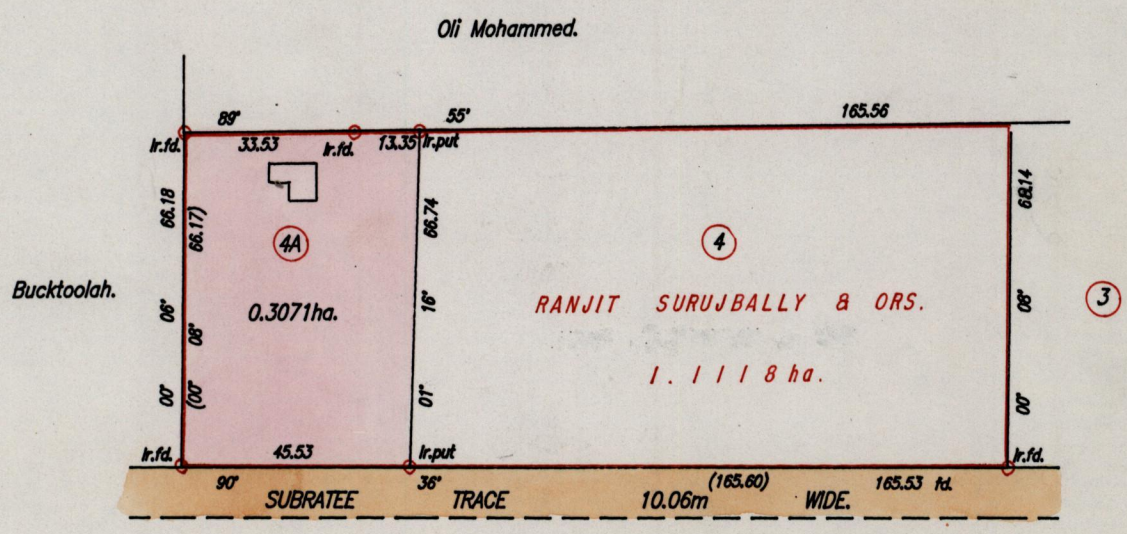

Approved *[Signature]*
Director of Surveys
98 05 02

SCALE 1:1500

Bearings are based on Solar Observations

Distances are in metres

PLAN of a Parcel of land coloured pink in the Ward of Savana Grande.

Containing zero point three zero seven one hectare.

Surveyed by me, with due authority, in July, 1997

I certify that I have complied with rule 76 under section 14(2)(d) of the Land Surveyor's Ordinance 1952, and that this plan is correct.

Checked by *[Signature]* 98.4.20

[Signature]

Entered

Land Surveyor, Trinidad & Tobago. 16th March 19.98.

Original Survey Bk. 1200 fol 35

