

No

1196

728
728

R.P.O. Vol.
C.T. Vol. 3096.

Fol.
Fol. 105

Borough of Arima.
County of St. George.
Cadastral Sheet B. 24. D. 24C
3/d.
3b

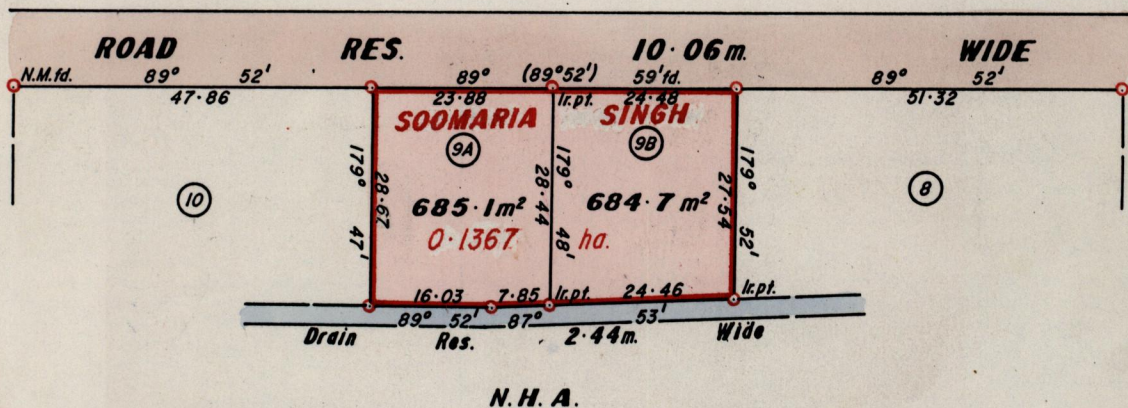

Handwritten note: 26/2/97

Approved

[Signature]

Director of Surveys
970310

○ Denotes Iron found except otherwise stated.

SCALE 1 : 1000.

Cassini Grid bearings based on Solar Observations.

Note: To obtain compass bearings add/minutes 08

Distances are in metres.

PLAN of 2 Parcels of land coloured pink in the Borough of Arima.

Containing together one thousand three hundred and sixty nine point eight square metres.

Surveyed by me, with due authority, in February 1996.

I certify that I have complied with rule 76 under section 14(2)(d) of the Land Surveyors' Ordinance 1952, and that this plan is correct.

Checked by *[Signature]* 24/2/97

[Signature]

Entered on Sht. 24C

Land Surveyor, Trinidad and Tobago 4th March 1996

Original Survey Bk: 1163:43

1901

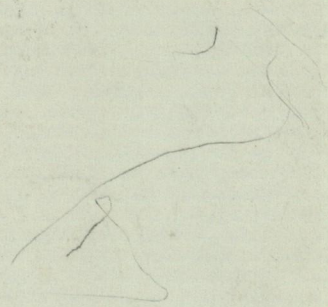

1196:728