

1196

719

Nº 893

R.P.O. Vol. 74  
C.T. Vol. 1654

Fol. 467  
Fol. 115

Ward of Tamana  
County of St. George  
Cadastral Sheet E.I.G. & H. 25E  
4/c

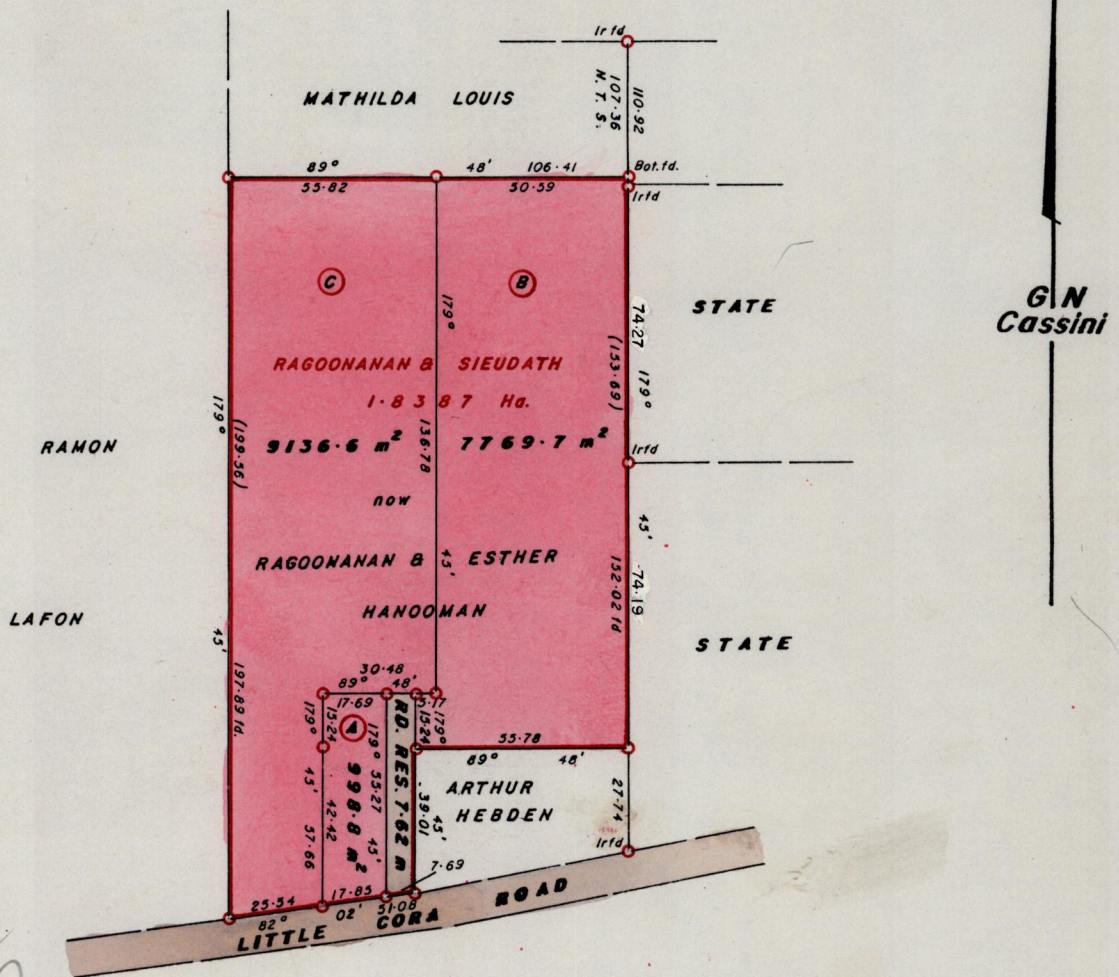

*A. [Signature]*  
18/2/97

Approved

*[Signature]*  
Director of Surveys

970226

SCALE 1:2000

○ Denotes Iron put except otherwise stated.

Note: To obtain compass bearings add/minutes

15 minutes

Distances are in metres .

PLAN of 3 Parcels of land coloured pink in the Ward of Tamana  
Containing together one point seven nine zero five hectares  
Surveyed by me, with due authority, in October, 1987 .

I certify that I have complied with rule 76 under section 14(2)(d) of the  
Land Surveyors' Ordinance 1952, and that this plan is correct.

Checked by *[Signature]* 27/1/97

*[Signature]*

Entered .....

Land Surveyor, Trinidad ..... 3 - 6 ..... 19 83  
and Tobago

917

Original Survey Bk. 780 fol. 19

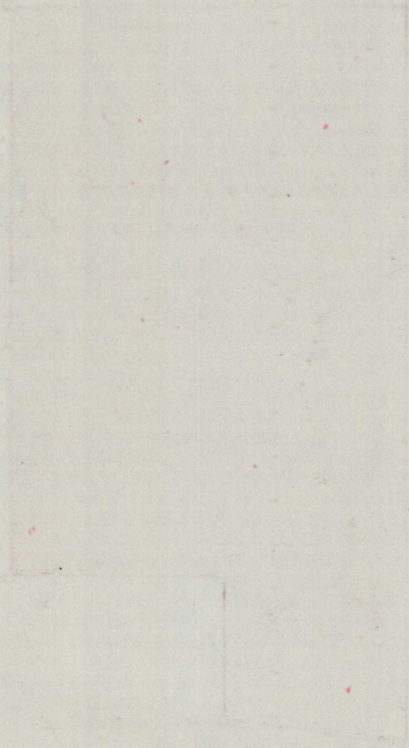

*[Faint, illegible handwritten text]*