

No 18432 1196

71

R.P.O. Vol. 97
C.T. Vol. 1651

Fol. 29
Fol. 259

Ward of St. Ann's
County of St. George
Cadastral Sheet A.20.L. $\frac{13E}{3/d}$

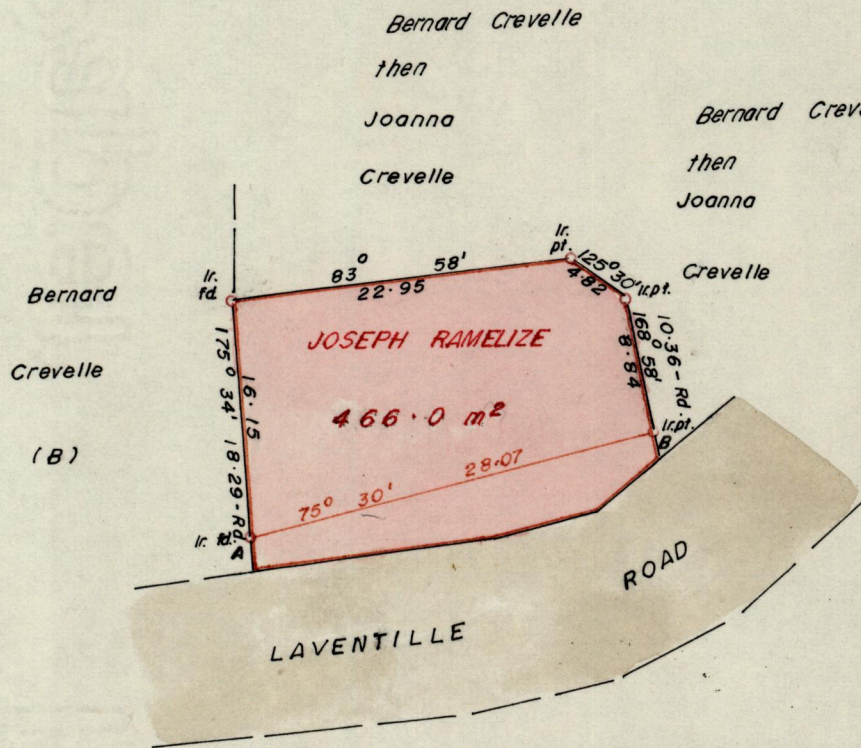

B Ir. pt.		
168° 58'	28.07	1.52
	22.00	4.0
	15.50	4.0
Ir. rd. 0	175° 34'	2.14
A 75° 30'		
n. t. s.		

Laventille Road

Approved

Lawrence Charles
 Director of Surveys
 9.1.09.19

SCALE 1:500

Note: To obtain compass bearings add/subtract / minutes Distances are in metres

PLAN of a Parcel of land coloured pink in the Ward of St. Ann's
 Containing four hundred and sixty - six point zero square metres
 Surveyed by me, with due authority, in Dec. 1990

I certify that I have complied with rule 76 under section 14(2)(d) of the Land Surveyors' Ordinance 1952, and that this plan is correct.

Checked by *G. Ramcharan* 13/1/91
H.P. Somarsingh

Entered Land Surveyor, Trinidad 26th February 1991

BR:1137: M E V. Crevelle

0811

7

2