

1196

707

64.A.
4/d.

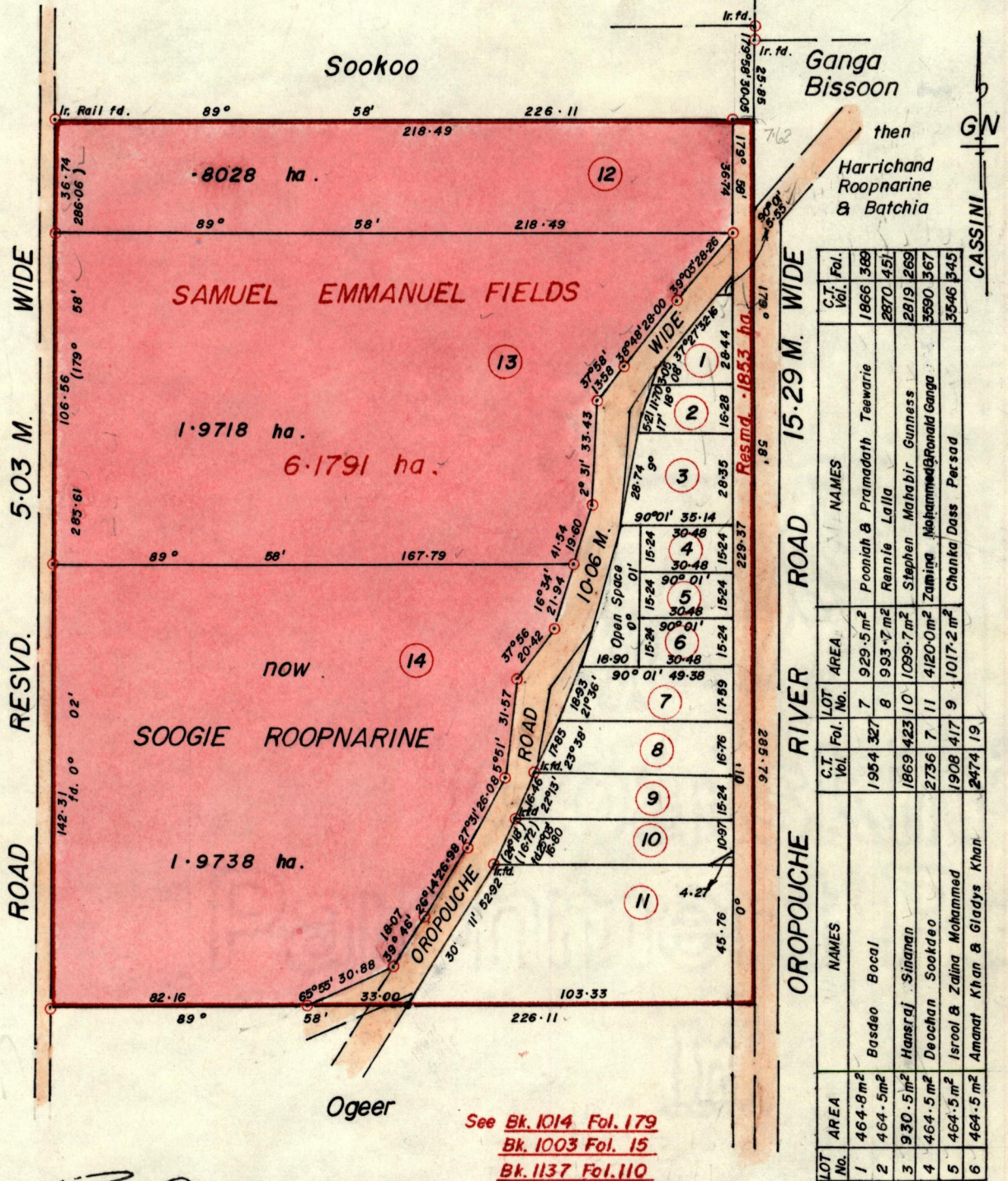

Approved, *[Signature]*
Director of Surveys
97 01 29

See Bk. 1014 Fol. 179
Bk. 1003 Fol. 15
Bk. 1137 Fol. 110
Bk. 1103 Fol. 178

○ Denotes Iron put except stated otherwise.

SCALE 1:2000.

Note: To obtain compass bearing subtract add 2 minutes Distance are in metres
PLAN of 3 Parcels of land coloured pink in the Ward of Savana Grande.
Containing together four point seven four eight four hectares.
Surveyed by me, with due authority, in June 1995.

I certify that I have complied with rule 76 under section 14(2)(d) of the Land Surveyors' Ordinance 1952, and that this plan is correct.

Checked by *[Signature]* 23/1/97
Entered.....

[Signature]
Land Surveyor, Trinidad 2/8/1995
and Tobago

333

333

Original Survey, Bk. 322 fol 167

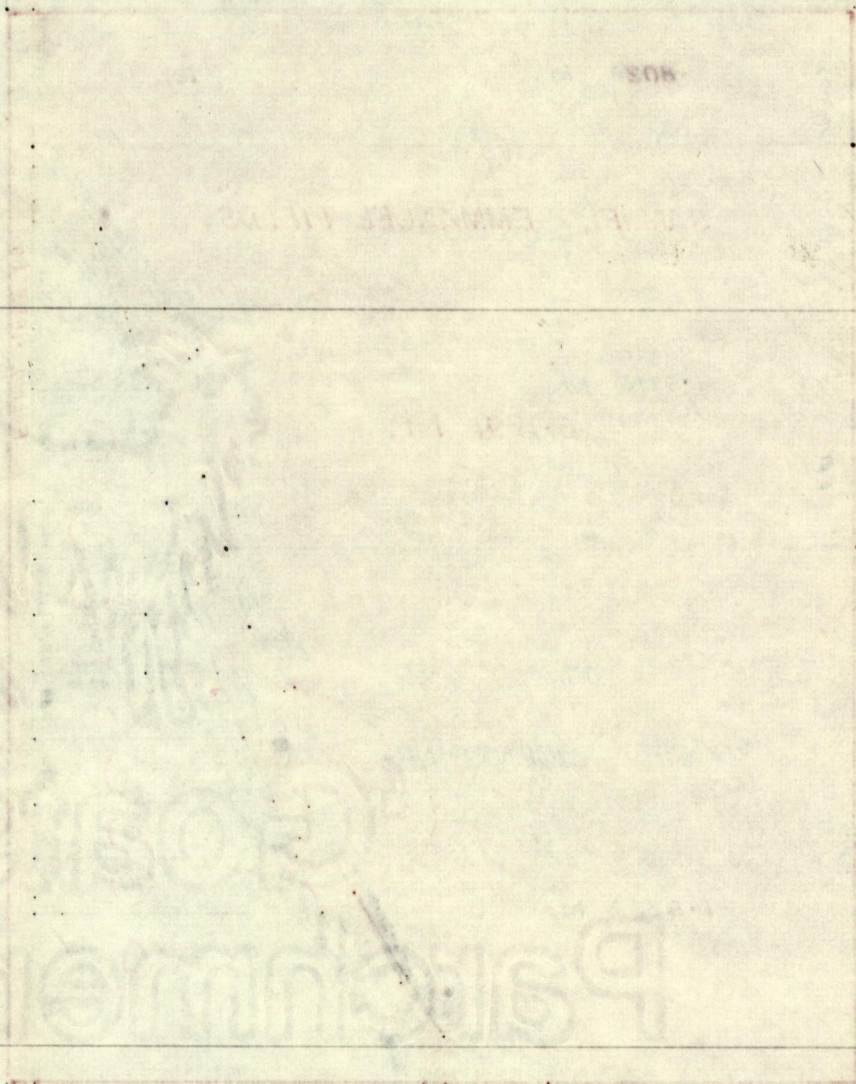

24 1/2
 21 1/2
 21 1/2
 21 1/2