

3604

REMAINING PORTION

L. & S.—56

R.P.O. Vol.

Fol.

1196

Cadastral Sheet I. 16. K $\frac{1F}{4/b}$ $\frac{1E}{4/b}$ 66

C. of T. Vol. 2350

Fol. 303

Ward of Tobago

Parish of St. Patrick

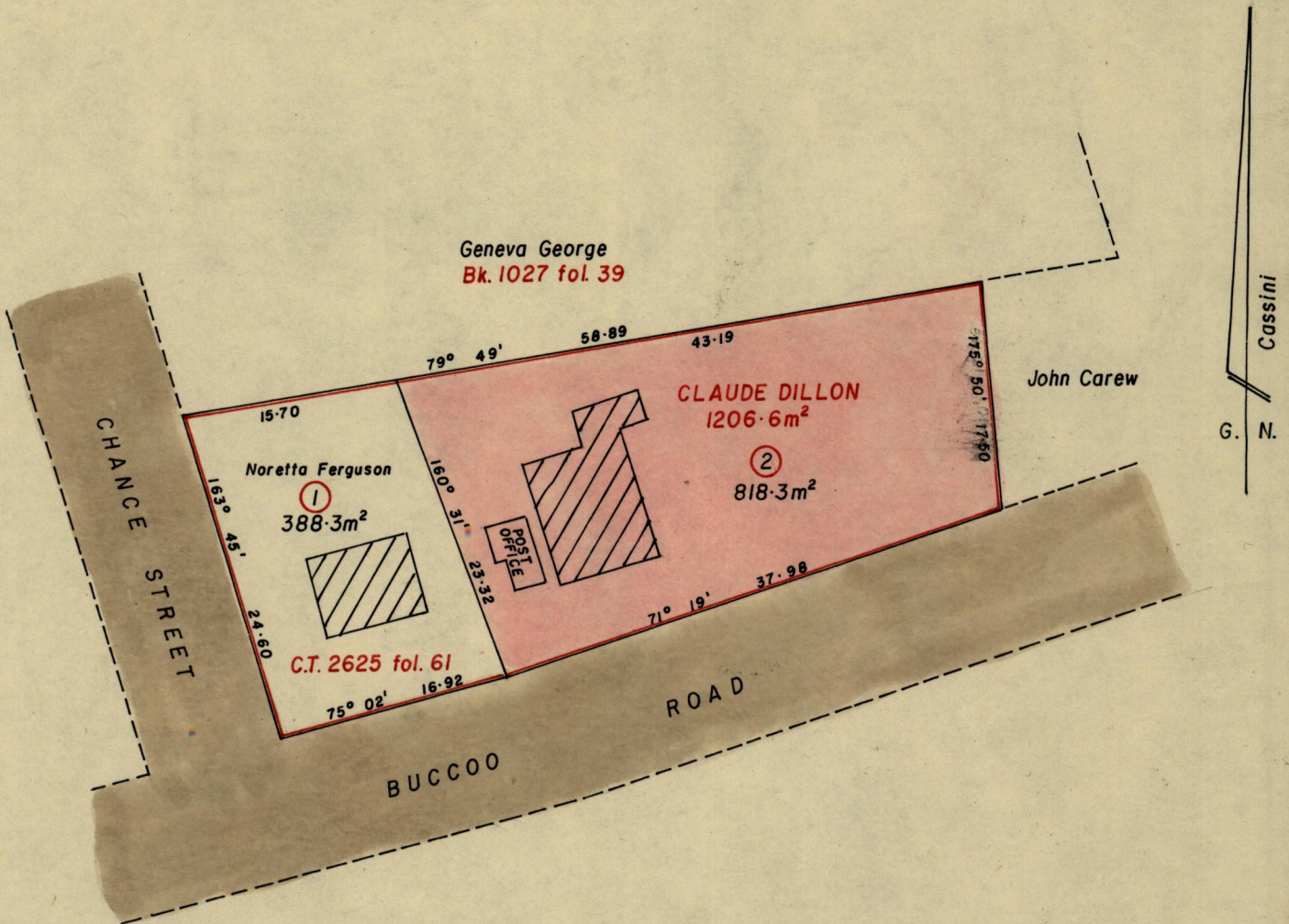

Approved

Eric Quintal

Director of Surveys

980415

Bearings are based on line St.10- St.11 S.O. 178/66

Note: To obtain compass bearings—subtract minutes

SCALE: 1/500

Distances are in metres

This is a true copy of a diagram of One thousand two hundred and six point six square metres. originally granted to Claude Dillon, shewing a portion coloured pink and containing eight hundred and eighteen point three square metres. being the remainder after one (1) previous transfer of another portion of the land. the dividing lines having been run in conformity with Rule 76 under Sec. 7 (a) of Cap. 27. No. 2 and duly certified by the Director of Surveys.

Checked by AMZ 98.4.9

Entered on

Leslie E. Skerrin

Land Surveyor, Trinidad, 3rd March 19.98

Original Survey Bk - 1137 Lot 183

