

1196

647

R.P.O. Vol. 138

Fol. 479

Ward of Siparia

C.T. Vol. 1210

Fol. 203

County of St. Patrick

Cadastral Sheet G.11.G. $\frac{62F}{2/d}$

Vide : Bk. 472 Fol. 165

Vide : Bk. 1135 Fol. 460

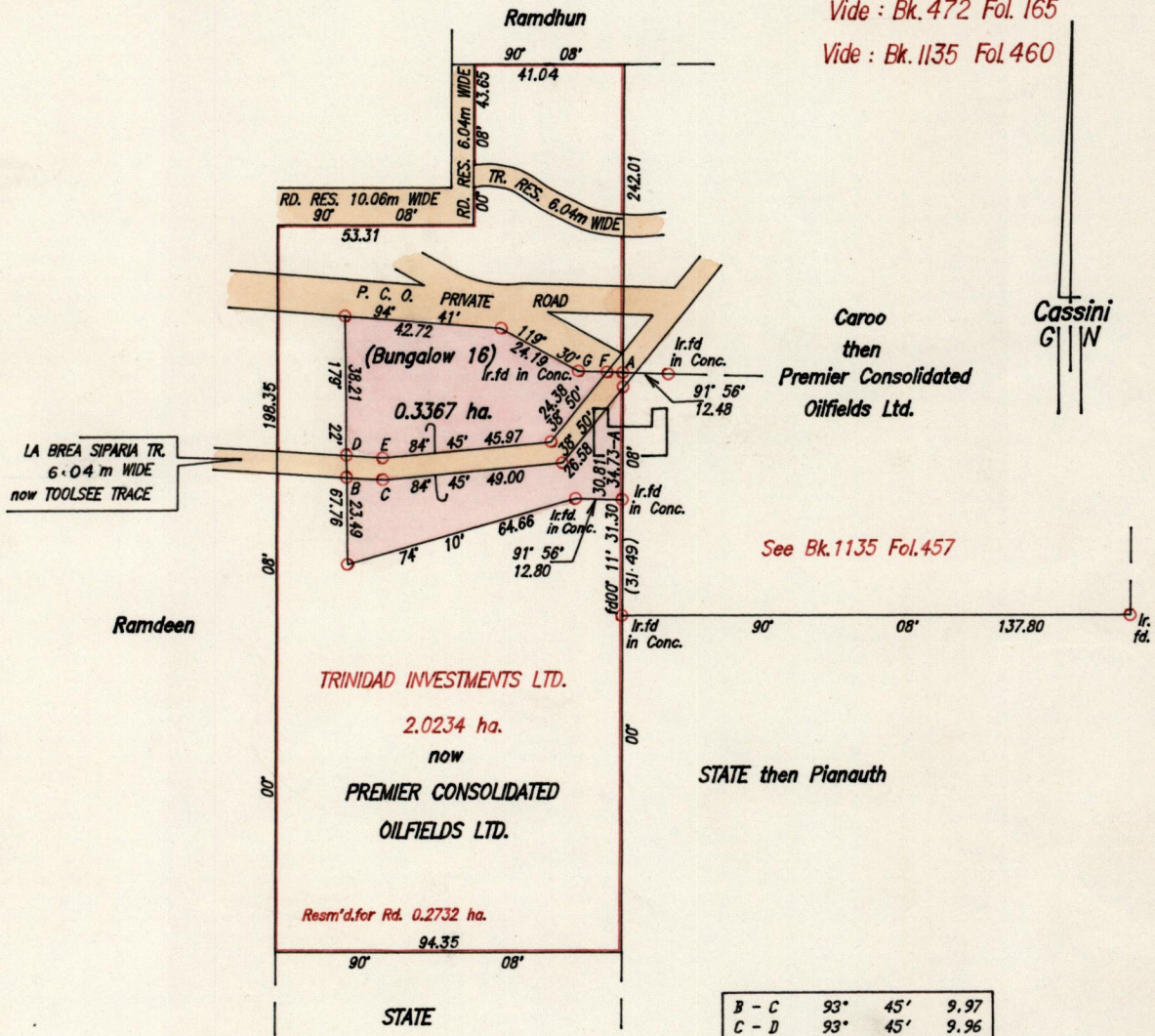

Approved.

G. Qualifield
Director of Surveys
961004

SCALE 1/2000

Distances are in Metres

- Denotes Iron put except otherwise stated
- Bearings are based on Solar Observations

PLAN of a Parcel of land coloured pink in the Ward of Siparia
Containing zero point three three six seven hectares

Surveyed by me, with due authority, in December 1994

I certify that I have complied with rule 76 under section 14(2)(d) of the
Land Surveyor's Ordinance 1952, and that this plan is correct.

Checked by *C. Johnson*
16/1/96

Ganeshdath Ramcharitar

Entered

Land Surveyor, Trinidad & Tobago

14/3/96
GANESH DATH RAMCHARITAR19. . . .
LAND SURVEYOR

Original Survey Bl. 472 fol 165

