

REMAINING PORTION

R.P.O Vol. 241  
C. T. Vol. 1302

Fol. 433  
Fol. 407

Ward of Siparia  
County of St. Patrick  
Cadastral Sheet (G.13.K)

63F  
4/a 63

1196

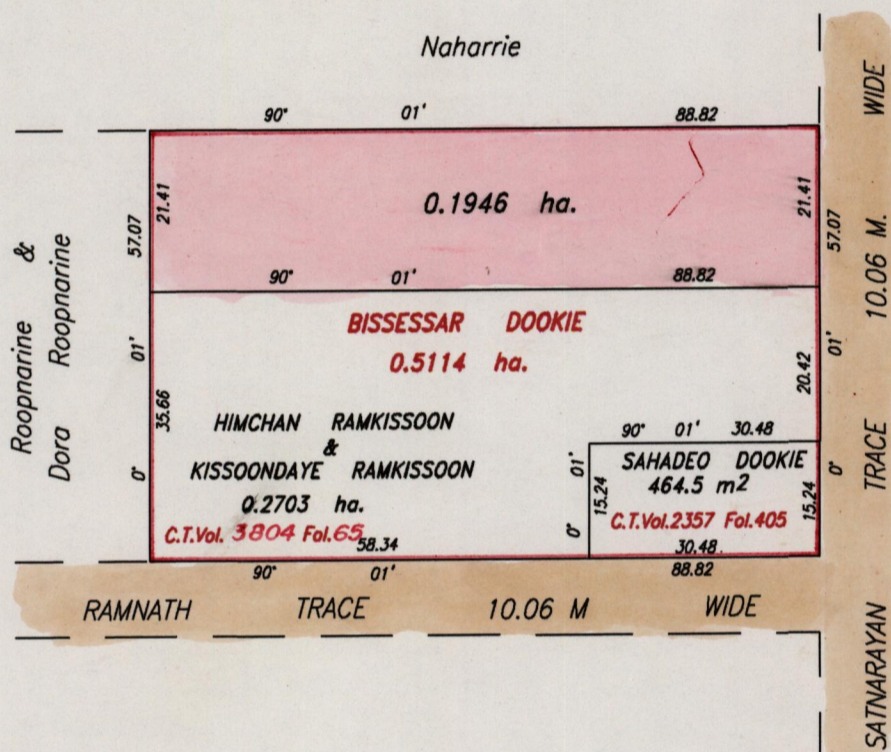
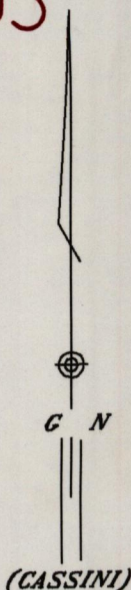

See Bk. 1145 Fol. 620

Approved by *[Signature]*  
Director of Surveys  
980413

SCALE 1/1000

Note: To obtain compass bearings subtract 1 minute. Distances are in metres  
This is a true copy of a diagram of point five one one four hectare originally transferred to Bisseessar Dookie shewing a portion coloured pink and containing point one nine four six hectare being the remainder after two (2) previous transfers of other portions of the land.  
The dividing lines having been run in conformity with Rule 76 under Sec. 14(2)(d) of the Land Surveyors' Ordinance 1952, and duly certified by the Director of Surveys.

Checked by *[Signature]* 31.3.98  
Entered on .....

*[Signature]*  
Land Surveyor Trinidad & Tobago ..... 9/2/1998

Original Survey Bk. 980 fol. 79

