

No

22240

1196

623

R.P.O. Vol.
C.T. Vol. 1958

Fol.
Fol. 367

Ward of *Pointe - a - Pierre*.
County of *Victoria*. 43F
Cadastral Sheet D.22C. 3/d.

Vide Bk. 1017 fol. 29
" " 1071 " 93

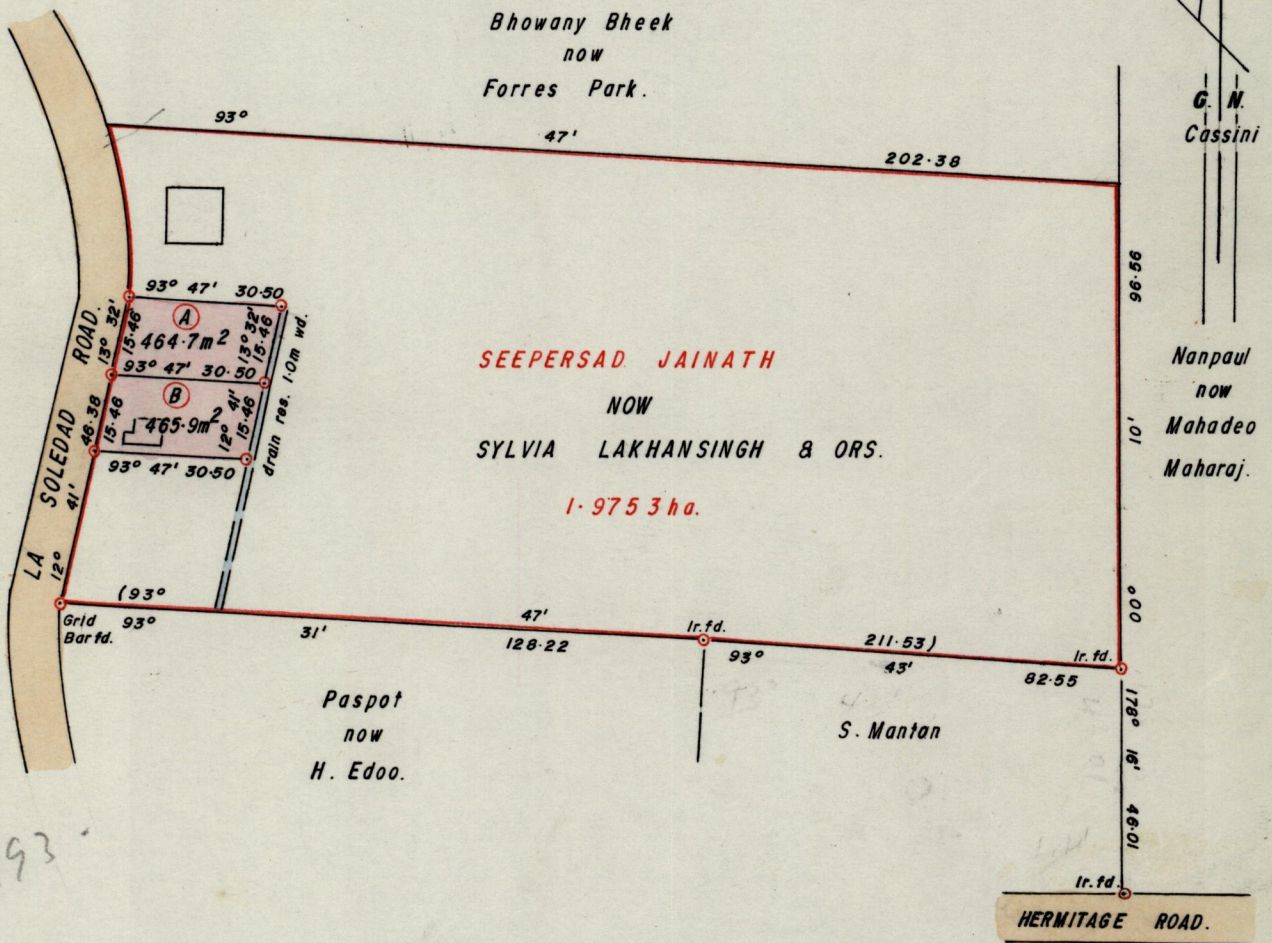

3/12/93

Approved

Francis Charles

Director of Surveys
93.12.07

Bearings are based on Solar Obs. (Cassini Grid.)

Note: To obtain compass bearings add/subtract

◦ Denotes Iron put except otherwise stated.

SCALE 1:1500

minutes

Distances are in metres.

PLAN of 2 Parcels of land coloured pink in the Ward of *Pointe - a - Pierre*.

Containing together nine hundred and thirty point six hectares.

Surveyed by me, with due authority, in November, 1992.

I certify that I have complied with rule 76 under section 14(2)(d) of the Land Surveyors' Ordinance 1952, and that this plan is correct.

Checked by *Shelby P Nov 93*

A. Deonanan

Entered

Land Surveyor, Trinidad 20th August 1993

J.S.
93/8/25

Orig. Survey Bk. 1017 fol. 29