

No

20226 1196

R.P.O. Vol. 773
C.T. Vol. 2580

Fol. 147
Fol. 467

Ward of Erin
County of St. Patrick
Cadastral Sheet $\frac{72F}{1/d}$, 621.B

VIDE PLAN AD 29

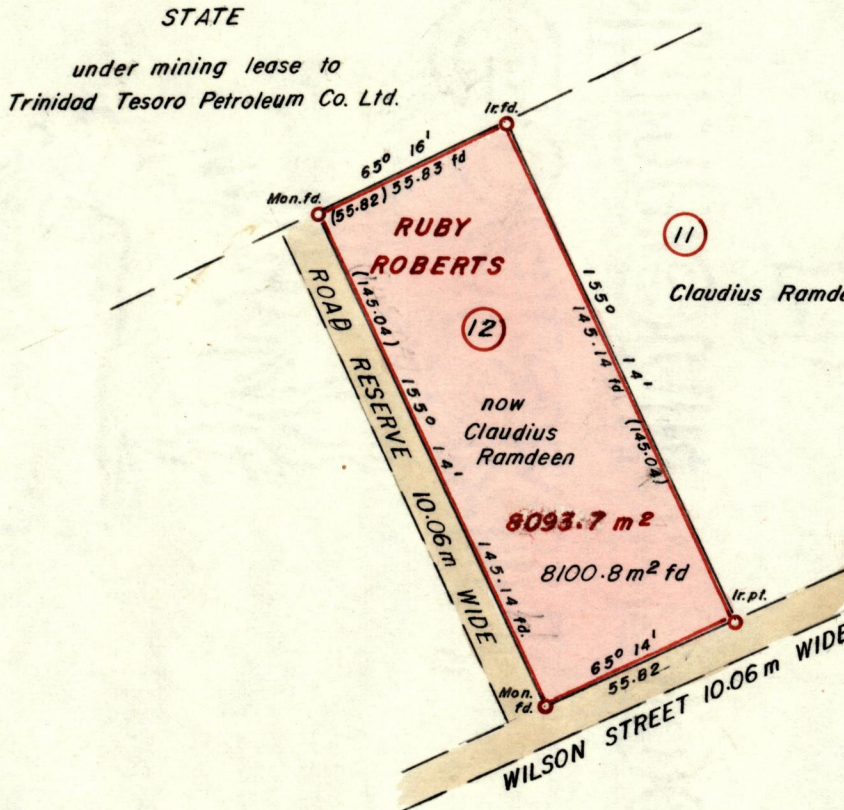

Approved

Lawrence Cole

Director of Surveys
91.07.16

SCALE 1:2000

Note: To obtain compass bearings add/subtract

minutes

Distances are in metres

PLAN of a Parcel of land coloured pink in the Ward of Erin
Containing eight thousand one hundred and eighty eight square metres
Surveyed by me, with due authority, in January 1991

I certify, that I have complied with rule 76 under section 14(2)(d) of the
Land Surveyors' Ordinance 1952, and that this plan is correct.

Checked by *G. Ramdeen* 18/7/91

J. Lewis
Land Surveyor, Trinidad and Tobago
4th APRIL 1991

Entered

J.S. 9/10/91

05505

Original Survey BK:- 736. Fol. 251.