

No 24819

R.P.O. Vol. 218
C.T. Vol. 1184

Fol. 597
Fol. 351

Ward of Siparia
County of St Patrick
Cadastral Sheet G.13.G. 63F/27C

GN

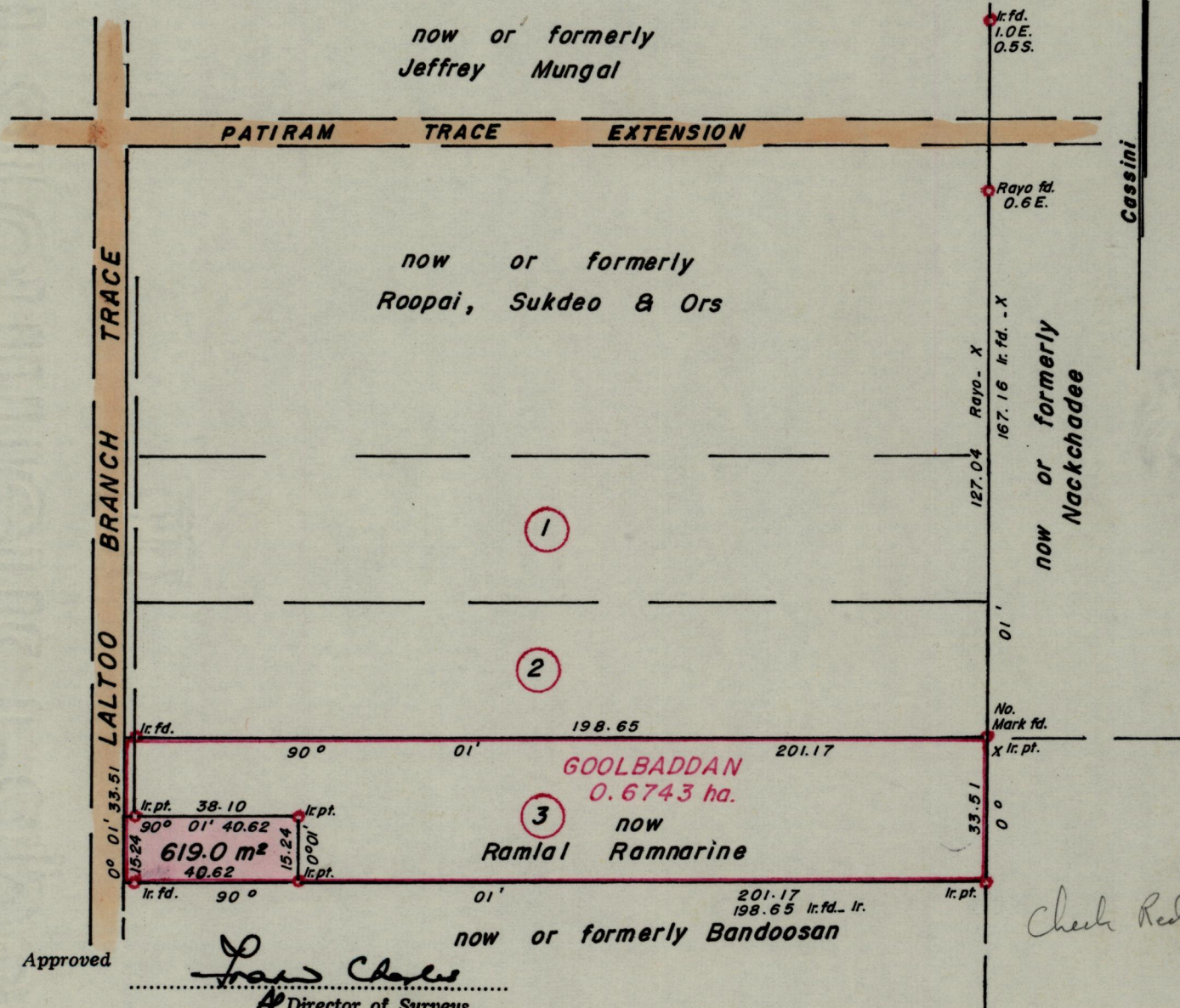

Approved

Law Charles
Director of Surveys
93-07-23

SCALE 1:1500

Bearings based on Solar obs.
Note: To obtain compass bearings add/subtract minutes

Distances are in metres

PLAN of a Parcel of land coloured pink in the Ward of Siparia

Containing six hundred and nineteen sq. metres

Surveyed by me, with due authority, in September 1991

I certify that I have complied with rule 76 under section 14(2)(d) of the Land Surveyors' Ordinance 1952, and that this plan is correct.

Checked by *A. Bodo 10/5/93*

[Signature] Haroey S. Ramrekha

Entered Land Surveyor, Trinidad 24-04-1993