

REMAINING PORTION

R.P.O. Vol. 214

Fol. 277

Cadastral Sheet 63.F, (G.13.K)  
4/a.

C.T. Vol. 959

Fol. 383

1196

Ward of Siparia

55

County of St. Patrick

G N

CASSINI

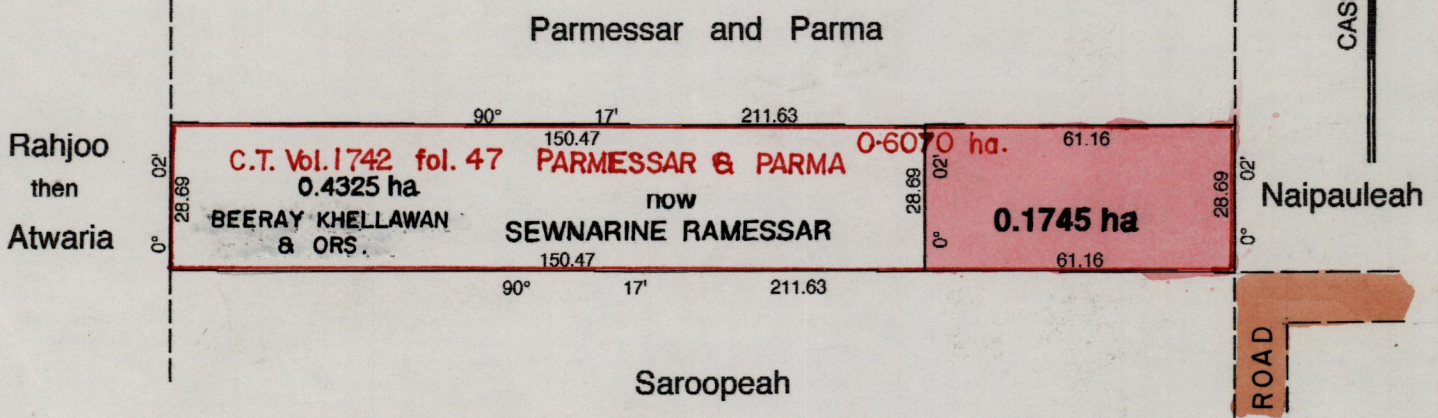

Vide Bk. 997 fol. 70

Approved *[Signature]*  
Director of Surveys  
980321

SCALE 1 : 1500

Bearings are Cassini Grid based on Solar Obs.

Distances are in metres

This is a true copy of a diagram of zero point six zero seven zero hectare originally transferred to PARMESSAR and PARMA, showing a portion coloured pink and containing zero point one seven four five hectare being the remainder after one (1) previous transfer of another portion of land.

The dividing lines having been run in conformity with rule 76 under section 14 (2) (d) of the Land Surveyors' Ordinance 1952, and duly certified by the Director of Surveys.

Checked by *[Signature]* *[Signature]* S. Ramrekha

Entered..... Land Surveyor, Trinidad & Tobago ..... 3. 07. 1997.

Original Survey Bk - 798 fol 150

