

R.P.O. Vol 118  
C.T. Vol. 2051

Fol. 511  
Fol. 233

Ward of Cocal  
County of Nariva  
Cadastral Sheet E220, 55B  
VIDE C.M. 112 4c/1

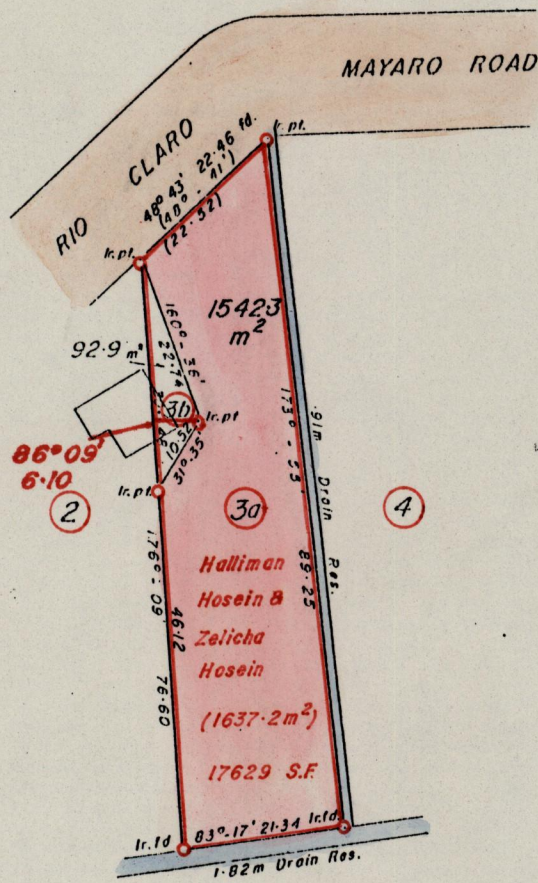

Chub C.M. 112

Approved Leon Chale  
Director of Surveys  
97-07-20

SCALE 1/1000

Note: To obtain compass bearings add/subtract minutes Distances are in Metres.

PLAN of a Porcc of land coloured pink in the Ward of Cocal.  
Containing One thousand five hundred and forty two point three sq. metres.  
Surveyed by me, with due authority, in August 1979:

I certify that I have complied with rule 76 under section 14(2)(d) of the  
Land Surveyors' Ordinance 1952, and that this plan is correct.

Checked by Asst. Dir. 28 June 93

Stamen Bely  
Land Surveyor, Trinidad 1993

Entered .....

89A

Original Plan C.M. 112

115

112

111

112

112  
111

112  
111

112