

REMAINING PORTION

1196

432

R.P.O. Vol. 62 Fol. 241

Ward of Siparia

C.T. Vol. 1324 Fol. 277

County of St. Patrick

Cadastral Sheet G.13.F 63F
1/c

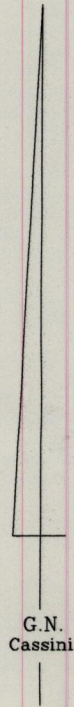
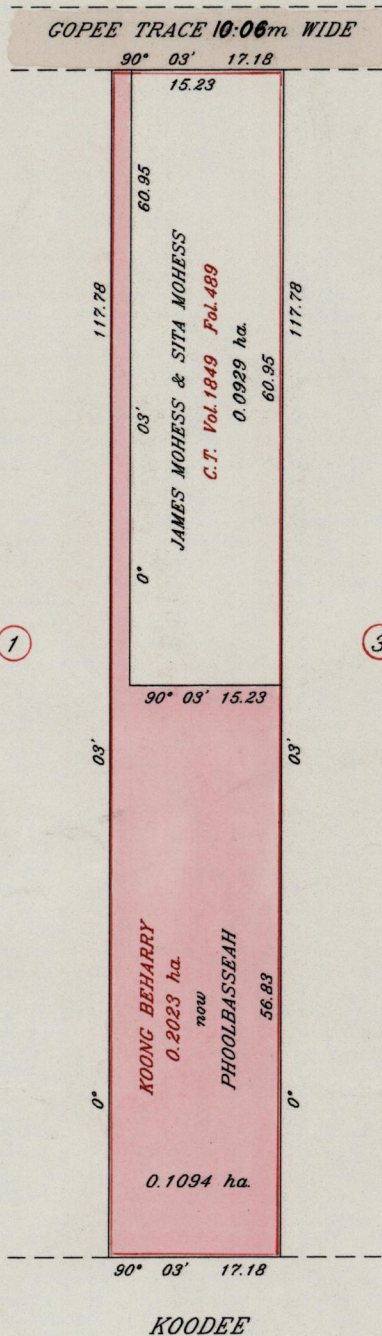

Approved *[Signature]*
 Director of Surveys
 28.10.14

VIDE: Bk.1012 Fol.10

SCALE 1: 750

Distances are in metres

This is a true copy of a diagram of zero point two zero two three hectares originally transferred to KOONG BEHARRY, showing a portion coloured pink and containing zero point one zero nine four hectares being the remainder after one (1) previous transfer of another portion of the land, the dividing lines having been in conformity with Rule 76 under Sec. 14(2)(d) of the Land Surveyors' Ordinance 1952 and duly certified by the Director of Surveys.

Checked by *[Signature]* 98.10.7

Entered

[Signature]
 Land Surveyor, Trinidad & Tobago
 9/9/1998

Original Survey Bk. 918 72. 157

