

616

REMAINING PORTION

R.P.O. Vol. 104

Fol. 597

1196

Cadastral Sheet G.12.B. $\frac{63D}{27b}$

463

C. of T. Vol. 802

Vol. 235

Ward of Siparia

County of St. Patrick

Rem. Portion Plan filed in R.P.O. Vol. 2295 Fol. 309

Bk. 980 Fol. 43

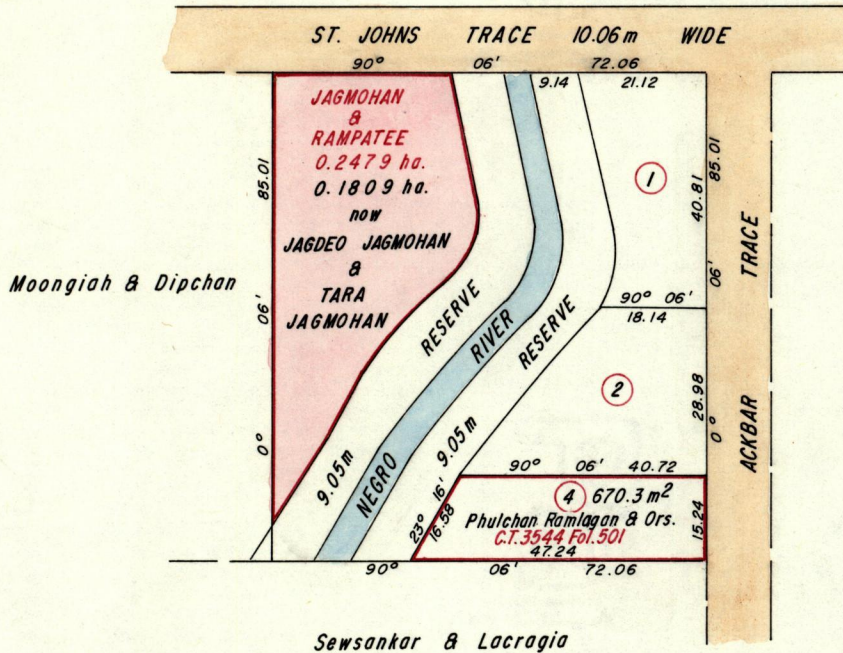
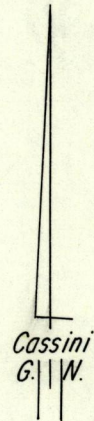

Approved

Law Chaw
Director of Surveys
93.06.07

SCALE 1:1250

Note: To obtain compass bearings ~~add~~ 6 minutes subtract

Distances are in Metres

This is a true copy of a diagram of zero point two four seven nine hectares originally transferred granted to Jagmohan & Rampatee, shewing a portion coloured pink and containing zero point one eight zero nine hectares being the remainder after one previous transfer of another portion of the land.

the dividing lines having been run in conformity with Rule 76 under Sec. ~~7(4) of Cap. 27, No. 2~~ ^{4(2)(d) of the Land Surveyors Ordinance 1952} and duly certified by the Director of Surveys.

Checked by *Abdul 27 May 93*

Entered on

Genshild Rensch
Land Surveyor, Trinidad, & Tobago

24/5/93

19.....

orig BK 980 fol 43

Faint, illegible text, likely bleed-through from the reverse side of the page.