

R.P.O. Vol. Fol.  
C. of T. Vol. 1331 Vol. 249

Cadastral Sheet G.14.M. & L. 64D/37c  
Ward of Siparia  
County of St. Patrick

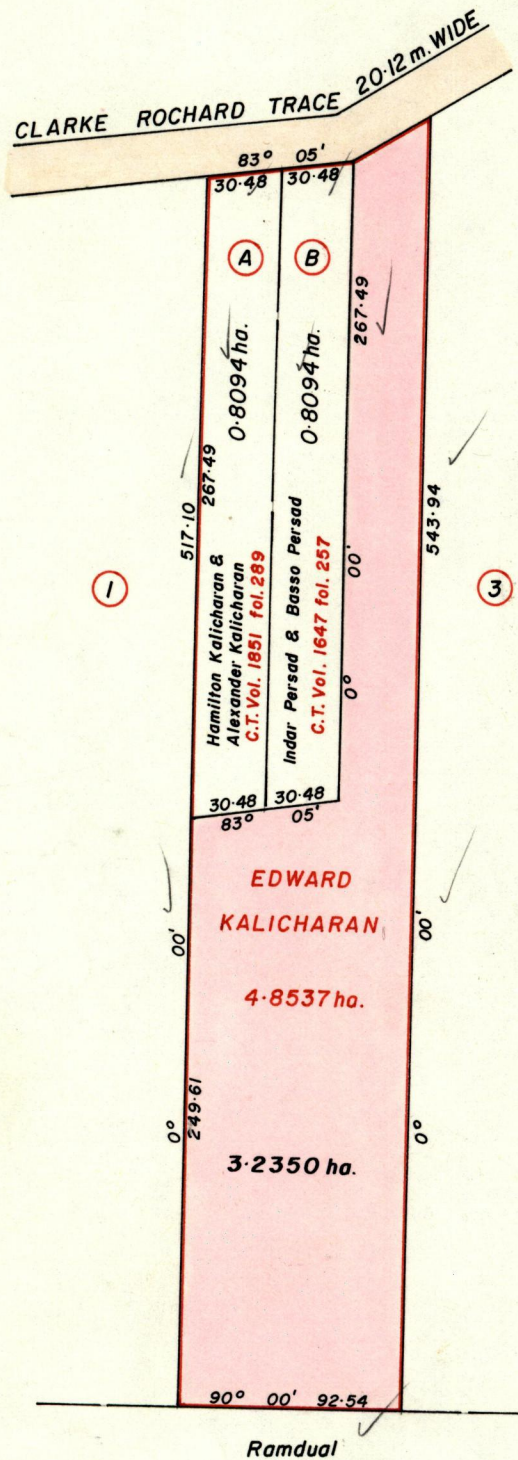

Handwritten note: 7/5/93

See Blc. 923

Approved

*Jean Charles*  
Director of Surveys  
93.05.10

Ramdual

SCALE 1:3168

Note: To obtain compass bearings add subtract minutes Distances are in metres

This is a true copy of a diagram of four point eight five three seven hectares originally transferred ~~granted~~ to EDWARD KALICHARAN, shewing a portion coloured pink and containing three point two three five zero hectares being the remainder after two previous transfer of another portion of the land. the dividing lines having been run in conformity with Rule 76 under Sec. 7(d) of Cap. 27, No. 2 and duly certified by the Director of Surveys.

Checked by A. B. 29/3/93

Entered on

*Albert H. Haynes*  
Land Surveyor, Trinidad, 10<sup>th</sup> February 1993

Original in Ms. 923 Fol. 140