

REMAINING PORTION

R.P.O. Vol. 119

Fol. 649

1196

Cadastral Sheet G.13.N. ^{63F.} 3/c

362

C. of T. Vol. 3560

Vol. 371

Ward of Siparia.

County of St. Patrick.

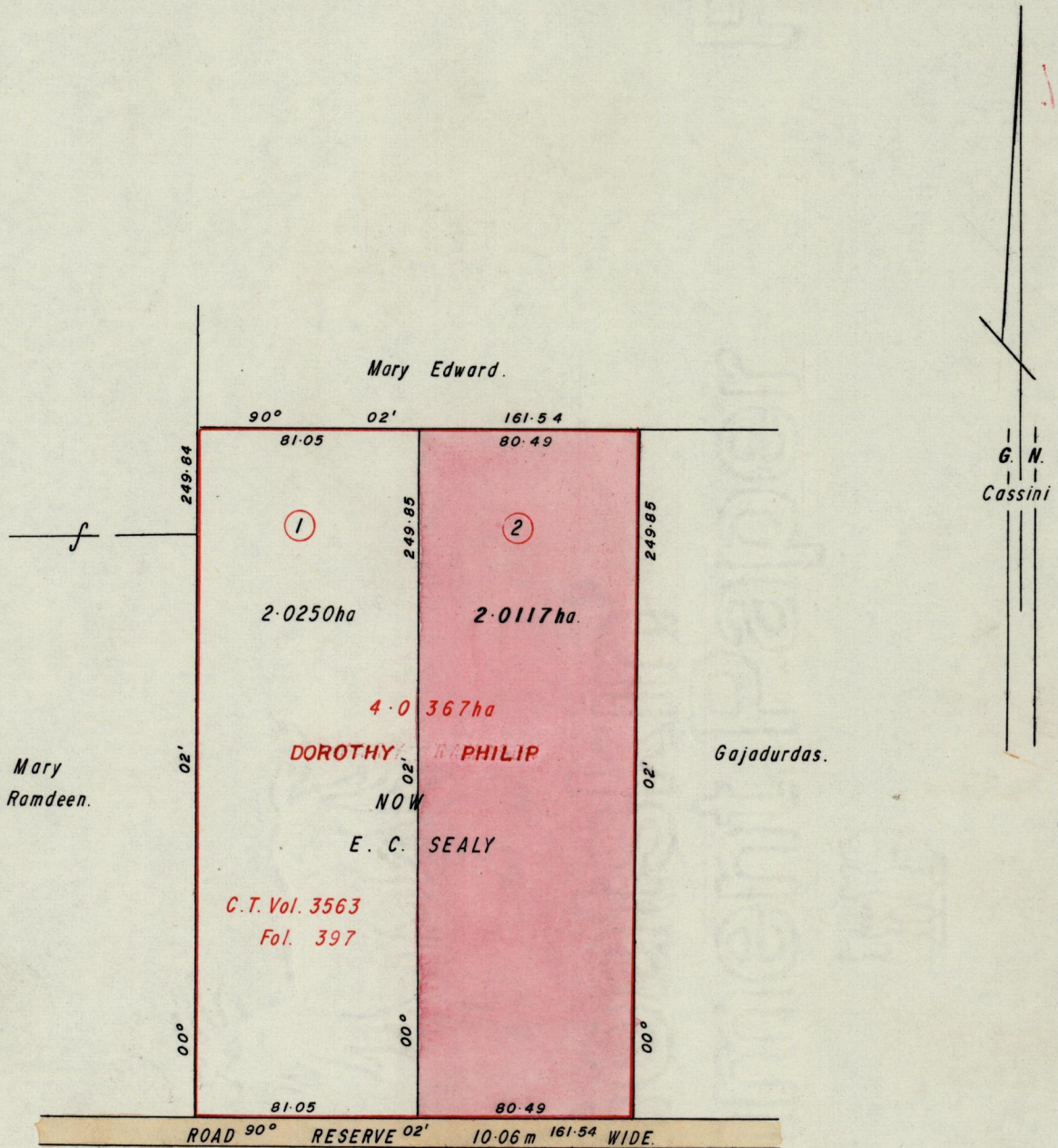

10/3/93

Approved

James Charles
Director of Surveys
93.03.10

SCALE 1:2500

Note: To obtain compass bearings ~~add~~ 2 minutes ~~subtract~~

Distances are in metres.

This is a true copy of a diagram of four point zero three six seven hectares originally granted to MARY RAMDEEN, shewing a portion coloured pink and containing two point zero one one seven hectares. being the remainder after one previous transfer of another portion of the land. the dividing lines having been run in conformity with Rule 76 under Sec. 7(d) of Cap. 27. No. 2 and duly certified by the Director of Surveys.

Checked by *A. B. D.* 5/3/93

Entered on

Kennon Pinard

Land Surveyor, Trinidad, 12th November 1922.

ORIG BK 396 fol 71