

R.P.O Vol. 5
C.T. Vol. 316
Fol. 285
Fol. 533

REMAINING PORTION PLAN

Cadastral Sheet (E-2-J) 1/6 & 2/6
Ward of Turure
County of St. Andrew

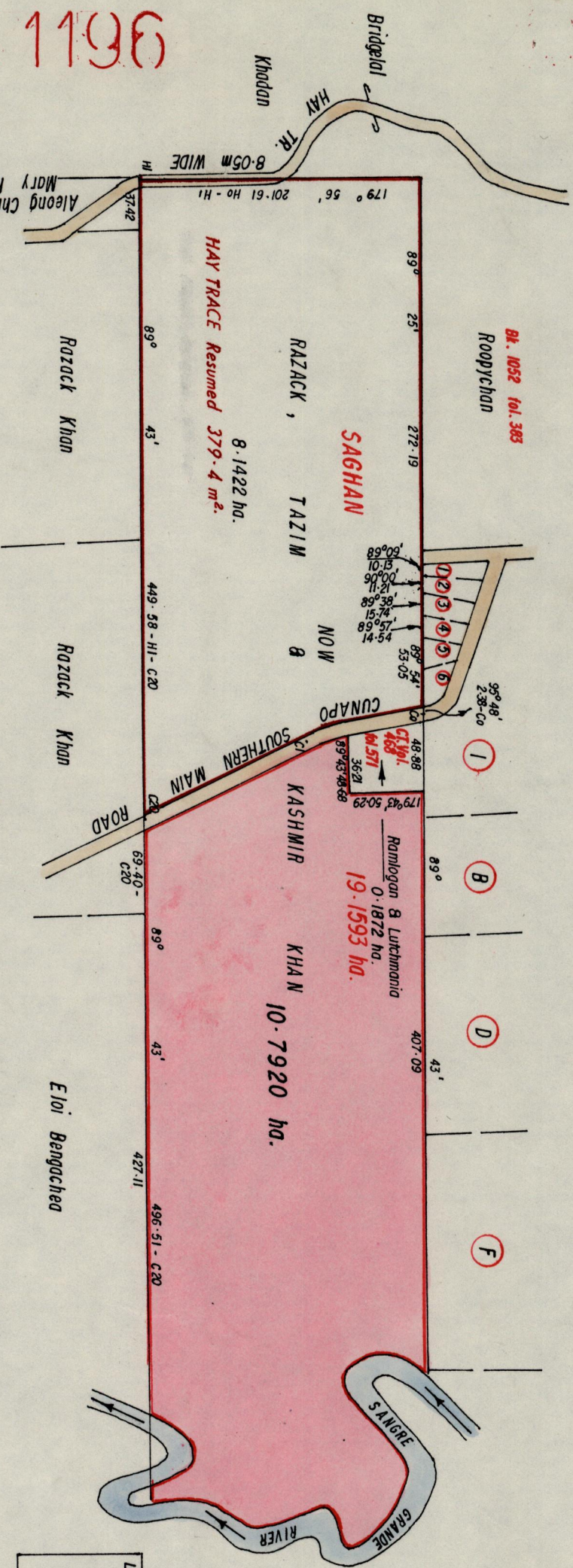

LOT No.	CT.Vol.	Fol.	NAMES
1	2923	501	R. Kallio
2	1645	207	A. Xavier
3	1645	207	A. Xavier
4	2928	449	S. Thomas
5	2883	149	M. Lamblin
6	1645	207	A. Xavier

Approved *Jean Charles*
Director of Surveys 93.03.10

SCALE 1/4000

Note: To obtain compass bearings add/subtract minutes Distances are in metres
This is a true copy of a diagram of nineteen point one five nine three hectares, originally granted to SAGHAN, shewing a portion coloured pink and containing ten point seven nine two zero hectares being the remainder after one resumption and two previous transfer of another portion of the land.
the dividing lines having been run in conformity with Rule 76 under section 14(2)(d) of the Land Surveyors' Ordinance 1951 by the Director of Surveys.
Checked by *H. Davis/S/193*
Entered

Luistone Ransdane
Land Surveyor, Trinidad 12th March 1992

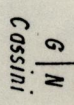

322

1199

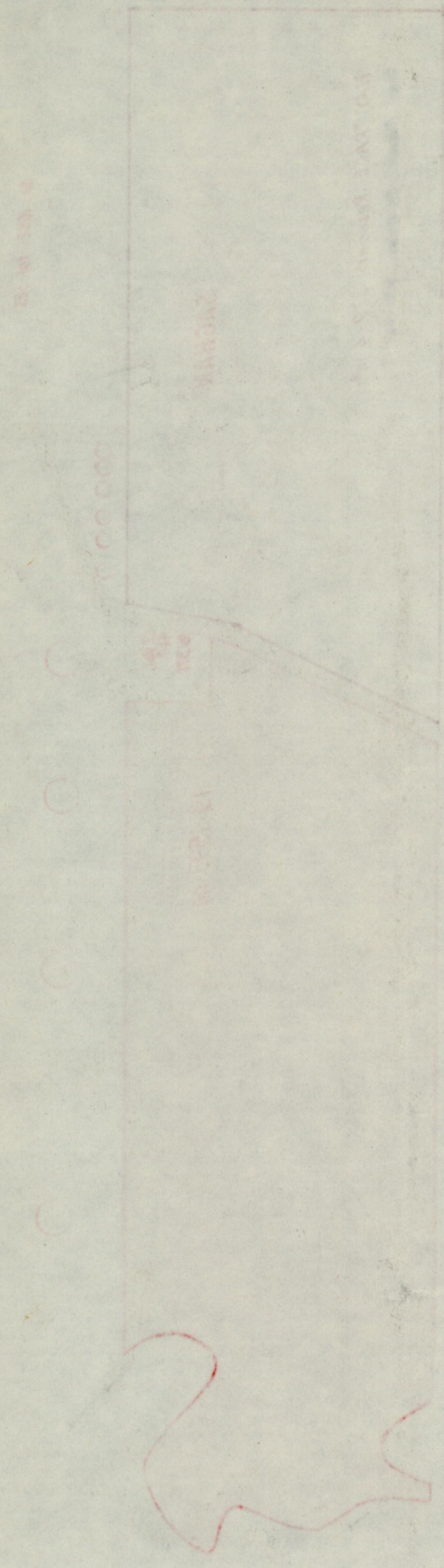

100
 40
 200
 200

Long BK 718 fol. 129

Printed by the University of Toronto