

344

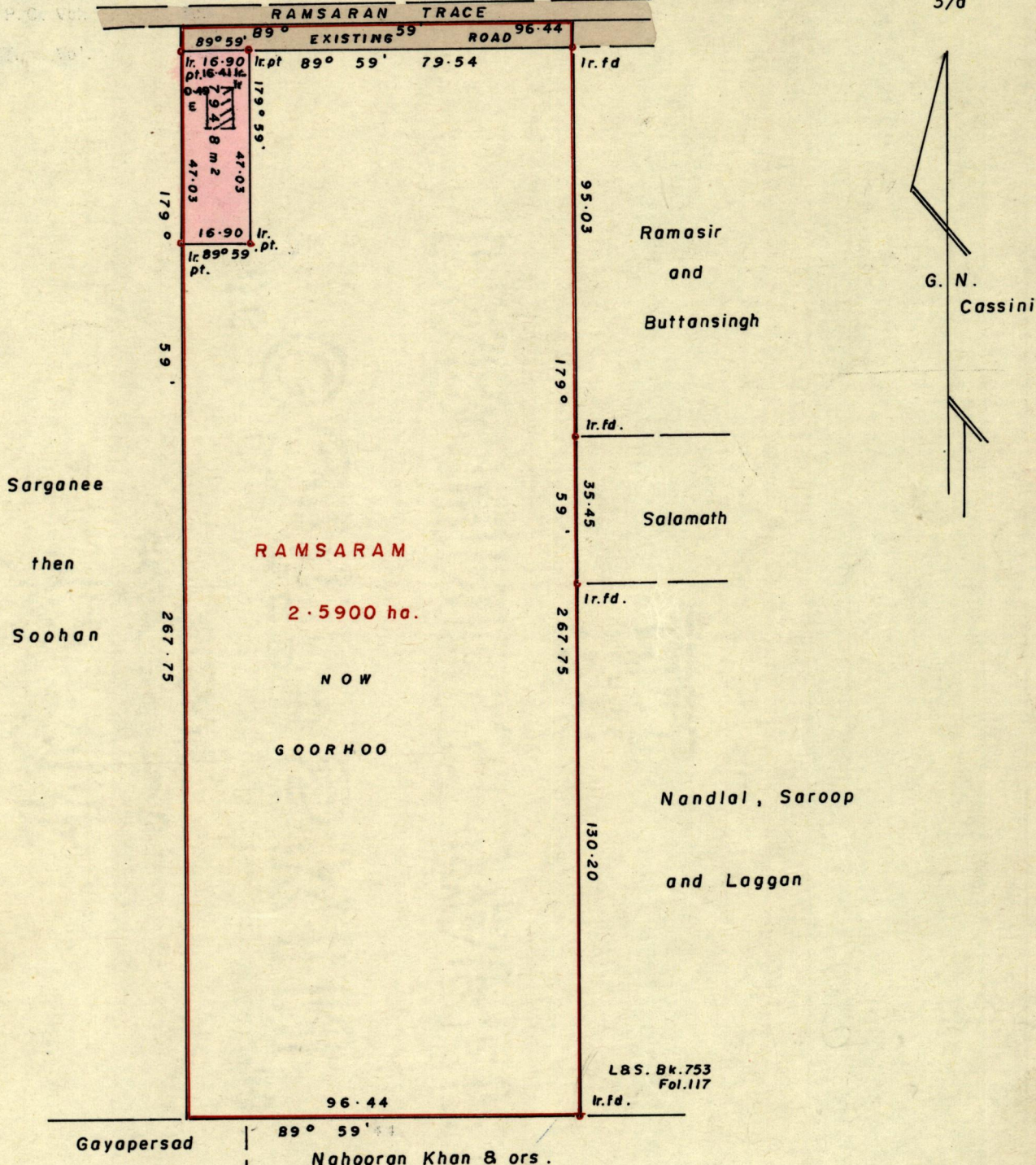

Approved

*[Signature]*  
 Director of Surveys  
 28.11.24

SCALE : 1/1500

Note: To obtain compass bearings add/subtract 1 minutes Distances are in metres  
 PLAN of a Parcel of land coloured pink in the Ward of Cunupia  
 Containing seven hundred and ninety four point eight square metres  
 Surveyed by me, with due authority, in March 1994

I certify that I have complied with rule 76 under Section 14 (2) (d) of the Land Surveyors' Ordinance 1952, and that this plan is correct.

Checked by AMZ. 98.7.30

*[Signature]*  
 KRISHNA RAMLAKHAN  
 Land Surveyor, Trinidad 25th April 1998

Entered.....



Original BK 76:202 ?

Original BK 76 fol 202

