

No 29025

1196

336

R.P.O. Vol. 3
C.T. Vol. 1007

Fol. 355
Fol. 441

Ward of Manzanilla
County of St. Andrew
Cadastral Sheet c.22.M. $\frac{25F}{1/b}$

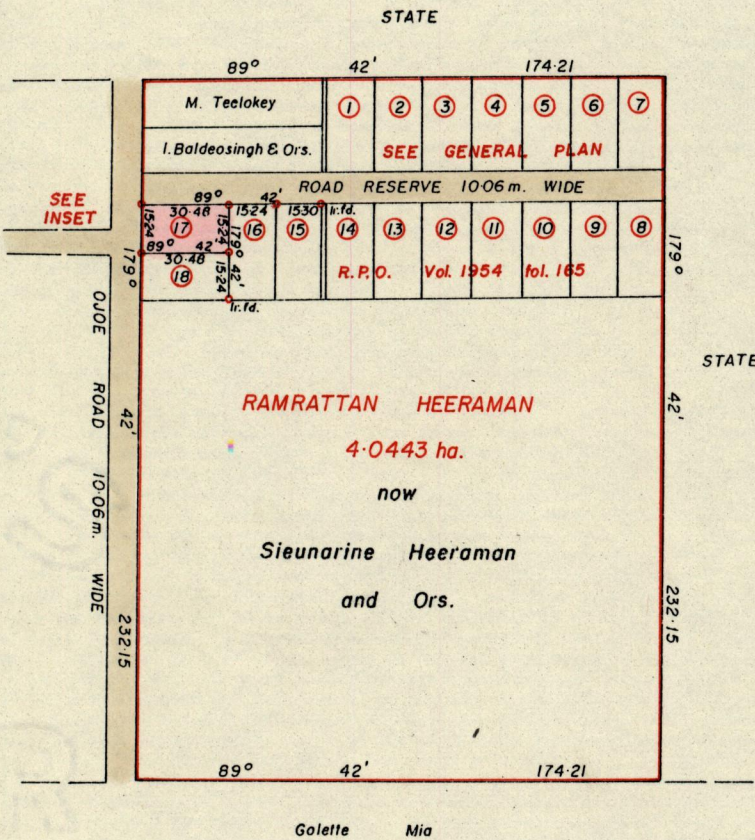

Scale 1:2500
Distances are in metres

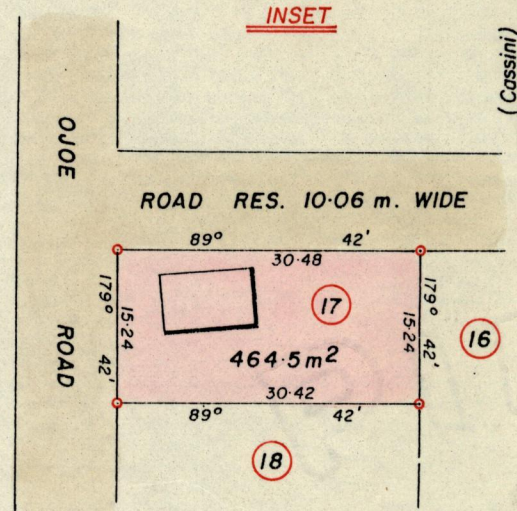

Approved

Paul Charles

Director of Surveys
93-01-06

Bearings are based on Solar Observations

○ Denotes Iron put unless otherwise stated.

Note: To obtain compass bearings add/subtract 18 minutes

SCALE 1/750

Distances are in metres

PLAN of a Parcel of land coloured pink in the Ward of Manzanilla

Containing four hundred and sixty-four point five square metres

Surveyed by me, with due authority, in March 1992

I certify that I have complied with rule 76 under section 14(2)(d) of the Land Surveyors' Ordinance 1952, and that this plan is correct.

Checked by *A. Basu 30/12/92*

Winston R. M. ...

Entered

Land Surveyor, Trinidad and Tobago

23/04 1992

Previous Survey Bk. 1005 - fol. 62

333

331