

No. 22861

1196

328

R.P.O. Vol. 118
C.T. Vol. 2167

Fol. 511
Fol. 533

Ward of Charuma
County of Nariva
Cadastral Sheet H.2.B. 55B
3/d

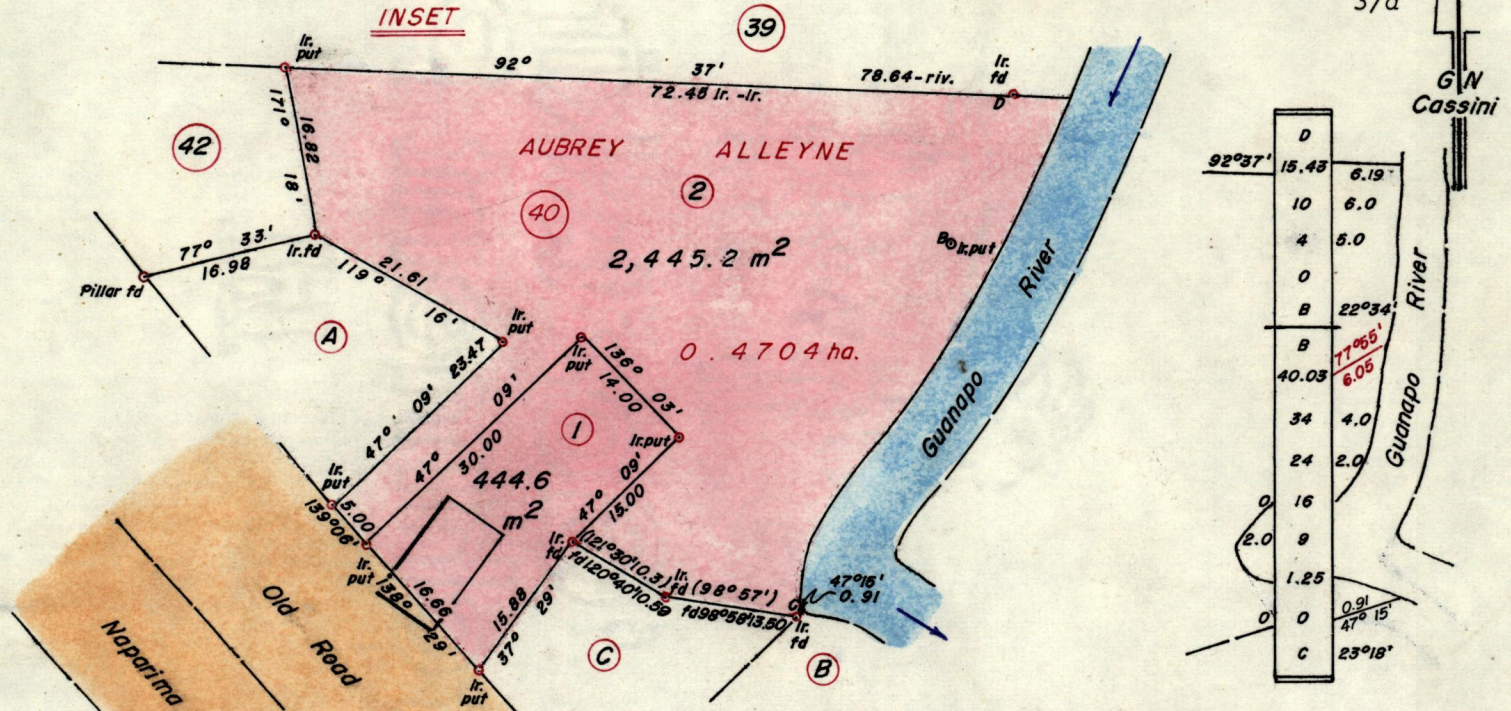

D	15.48	6.19
10	6.0	
4	5.0	
0		
B	22°34'	
B	77°05'	
40.03	6.05	
34	4.0	
24	2.0	
0	16	
2.0	9	
1.25		
0	0	0.91
0		47° 15'
C		23°18'

SCALE 1 : 2500
Distances are in Metres.

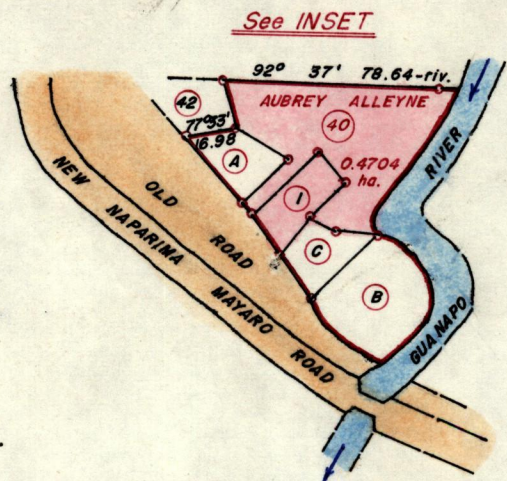

SCALE 1:750
minutes Distances are in Metres.

Approved *Lawrence Charles*
Director of Surveys
93-01-05

Bearings are based on Solar Obs.
Note: To obtain compass bearings add/subtract

PLAN of 2 Parcels of land coloured pink in the Ward of Charuma.
Containing together, two thousand eight hundred and eighty nine point eight sq. metres.
Surveyed by me, with due authority, in November, 1987.

I certify that I have complied with rule 76 under section 14(2)(d) of the Land Surveyors' Ordinance 1952, and that this plan is correct.

Checked by *A. S. 25/12/97*
Entered Land Surveyor, Trinidad & Tobago. 2nd September 19.97

See plan P.G. 67^A.

BSE

BOM

