

No 22850

1196 326

R.P.O. Vol. 14
C.T. Vol. 1754
See Bk.903 Fol.152

Fol. 449
Fol. 269

Ward of Naparima
County of Victoria
Cadastral Sheet G. 13. B. 63C
G. B. N. 3/c

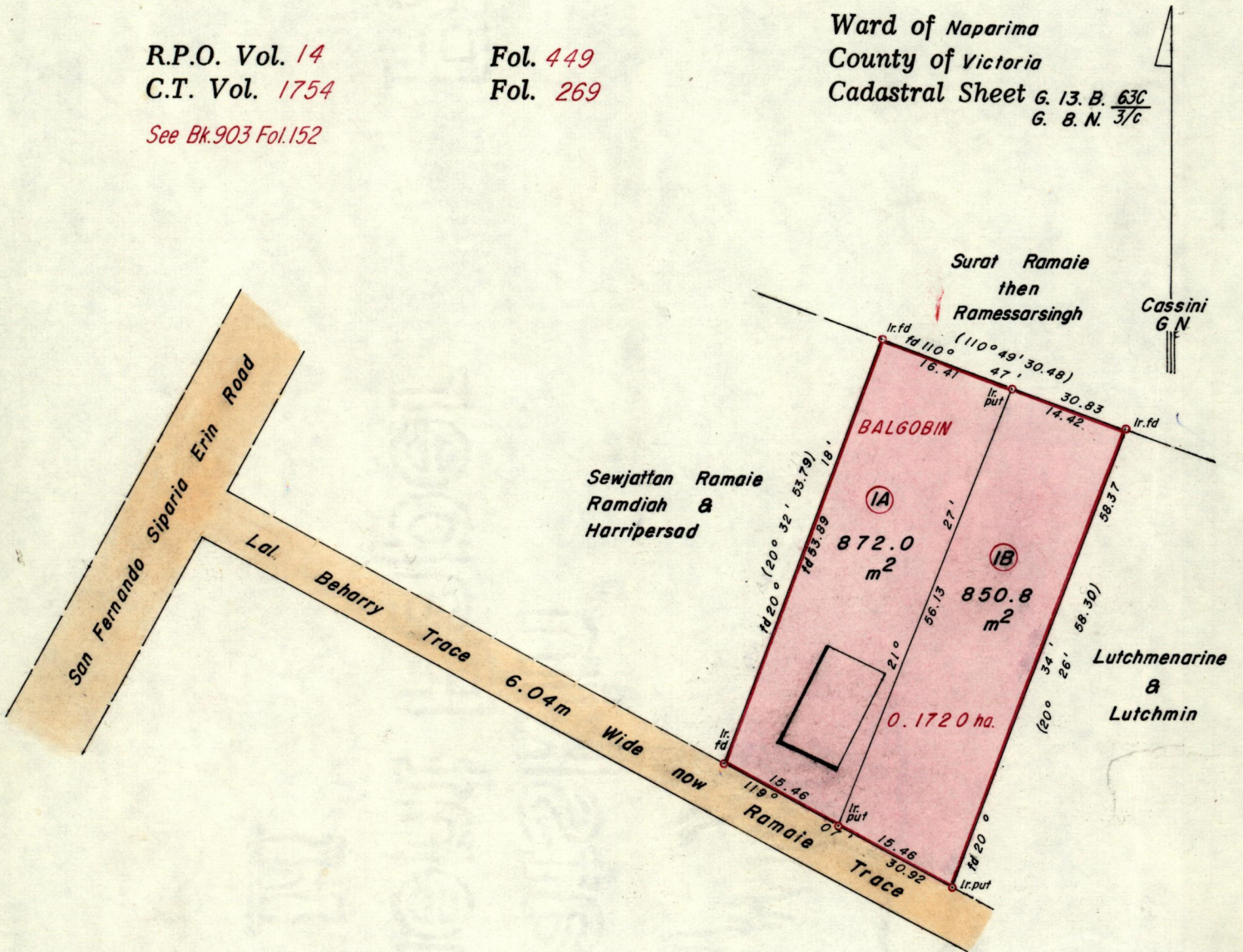

Approved

Law Chelo

Director of Surveys
92.12.03

Bearings are based on Solar Observations
Note: To obtain compass bearings add/subtract

SCALE 1 : 750
minutes

Distances are in Metres.

PLAN of 2 Parcels of land coloured pink in the Ward of Naparima.

Containing together, one thousand, seven hundred and twenty two point eight square metres.

Surveyed by me, with due authority, in August 1991.

I certify that I have complied with rule 76 under section 14(2)(d) of the Land Surveyors' Ordinance 1952, and that this plan is correct.

Checked by *A.D. 23/11/92*

Juman A.

Entered

Land Surveyor, Trinidad

29th June 19.92

Previous Survey Bk. 903 p. 152

35E

30N