

1196 317

Ward of Guayaguayare.
County of Mayaro.

Cadastral Sheet. H.5.E. ^{56E.} 2/b

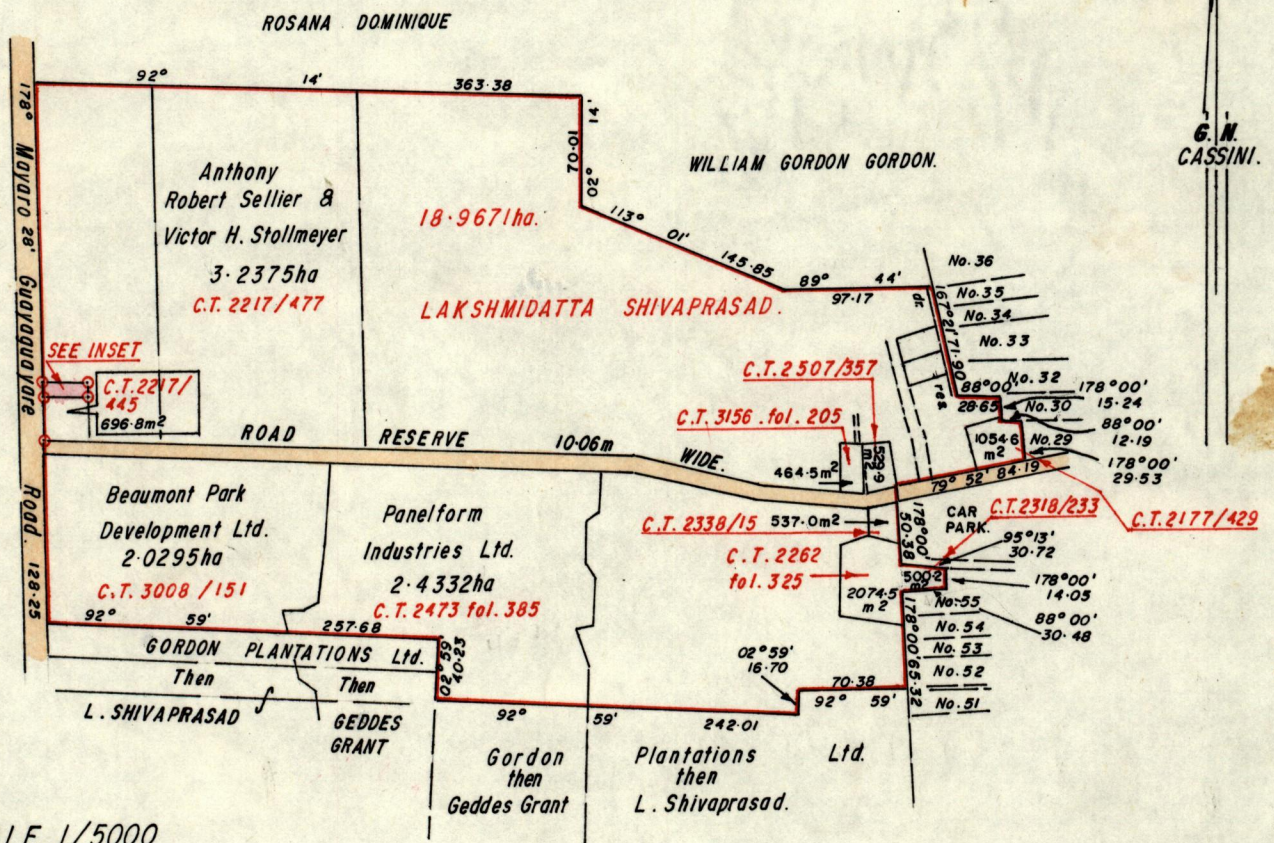

INSET

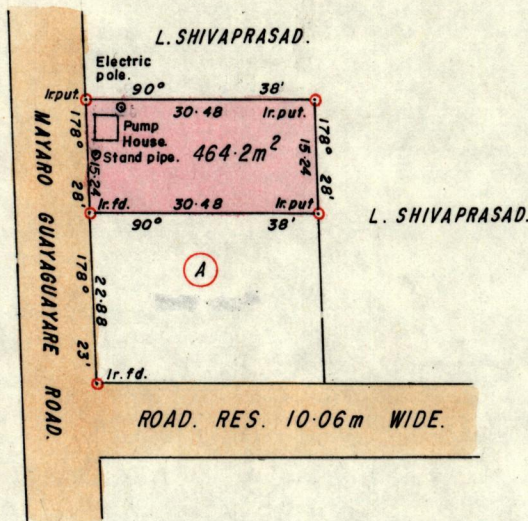

Approved

Lawrence Cassini

Director of Surveys

92-11-19

Bearings are based on Solar Observations (Cassini Grid.) SCALE 1/1000.

Note: To obtain compass bearings add/subtract minutes Distances are in metres.

PLAN of a Parcel of land coloured Pink in the Ward of Guayaguayare.

Containing four hundred and sixty four point two square metres.

Surveyed by me, with due authority, in July, 1991

I certify that I have complied with rule 76 under section 14(2)(d) of the Land Surveyors' Ordinance 1952, and that this plan is correct.

Checked by *[Signature]* 11/11/92

[Signature]

Entered

Land Surveyor, Trinidad 23rd August 1991

Orig Survey plan P.F. 176.

1800 1801

19 August 1801
Office of the Surveyor General