

No 11283

1196

3(1)

R.P.O. Vol. 105
C.T. Vol. 823

Fol. 29
Fol. 241

Ward of Siparia
County of St. Patrick
Cadastral Sheet $\frac{63F}{3/c}$, G.13. J.

Bk. 393 : 331
Vide S.O. 23 / 03

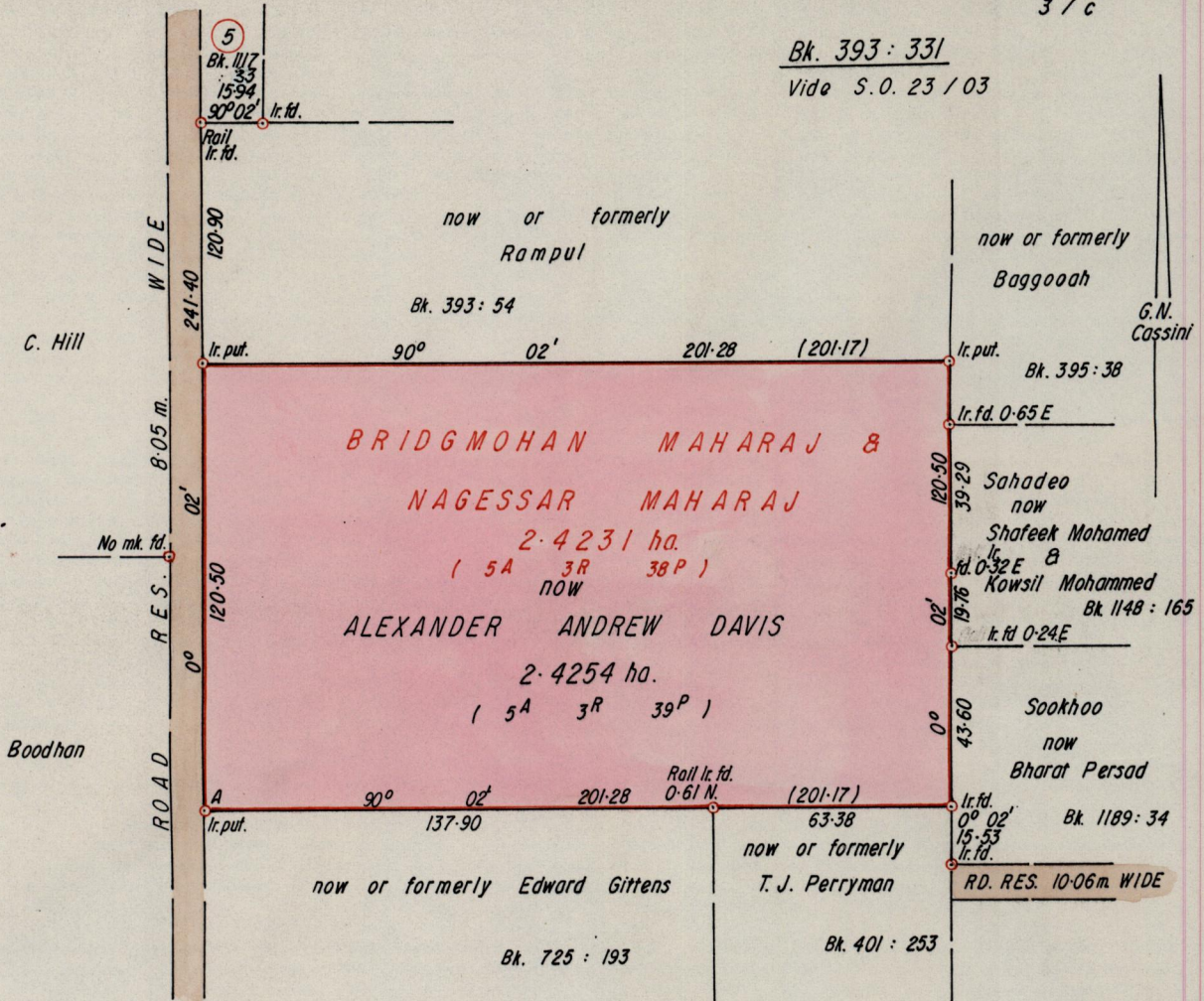

No mk. fd - A lr.put. 173° 25' 69.87

Approved *[Signature]*
Director of Surveys
9 980603

Bearings are Cassini based on Solar Obs.
Note: To obtain compass bearings add/subtract

SCALE 1 / 2000
minutes

Distances are in metres

PLAN of a Parcel of land coloured pink in the Ward of Siparia
Containing two point four two five four hectares
Surveyed by me, with due authority, in March 1998

I certify that I have complied with rule 76 under section 14(2)(d) of the
Land Surveyors' Ordinance 1952, and that this plan is correct.

Checked by *[Signature]* *[Signature]*
Entered Land Surveyor, Trinidad 20th April 19.98.

Original Survey Bk. 393 fol. 331

