

3748

1136
REMAINING PORTION

238

L. & S.—56

R.P.O. Vol. 11

Fol. 539

Cadastral Sheet 44F
T/a (D. 19. K)

C. of T. Vol. 516

Vol. 7

Ward of Montserrat

County of Caroni

G N (Cassini)

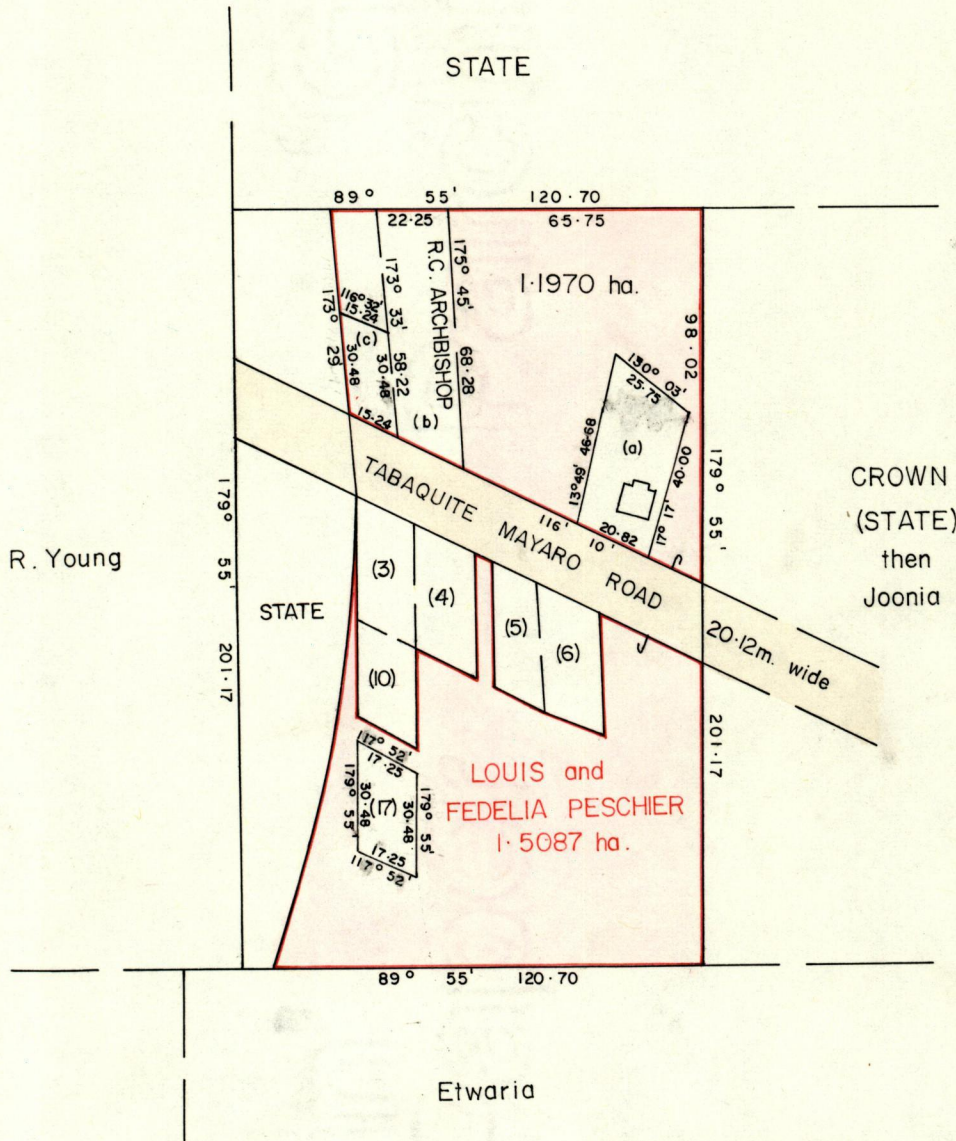

C. of T Vol.	Fol.	Area (m ²)	Parcel
516	15	455.5	Adolphus Abraham (17)
3473	155	942.6	Jerome Olivache (a)
633	71	1329.0	R.C. Archbishop (b)
634	247	389.3	Edward Chan Choy (c)

Approved

Land Charles
Director of Surveys
92.09.27

SCALE 1 : 2000

Note: To obtain compass bearings *add 5 minutes*
subtract

Distances are in METRES

This is a true copy of a diagram of one point five zero eight seven hectares originally transferred granted to LOUIS and FEDELIA PESCHIER, shewing a portion coloured pink and containing one point one nine seven zero hectares being the remainder after four previous transfer of another portion of the land.

the dividing lines having been run in conformity with Rule 76 under Sec. 4(2)(d) of the Land Surveyors Ordinance 1952 ~~7(d) of Cap. 27. No. 2~~ and duly certified by the Director of Surveys.

Checked by *J. R. R. R.*
16/7/92

Entered on

Paul Williams

Land Surveyor, Trinidad, 9/9/1992

Peewee's Survey is bk. 720 Feb. 84.