

605

1196  
REMAINING PORTION

L. & S.—56

29

R.P.O. Vol. 156

Fol. 317

Cadastral Sheet G.18.C. 736  
17b

C. of T. Vol. 1222

Vol. 155

Ward of Siparia

County of St. Patrick

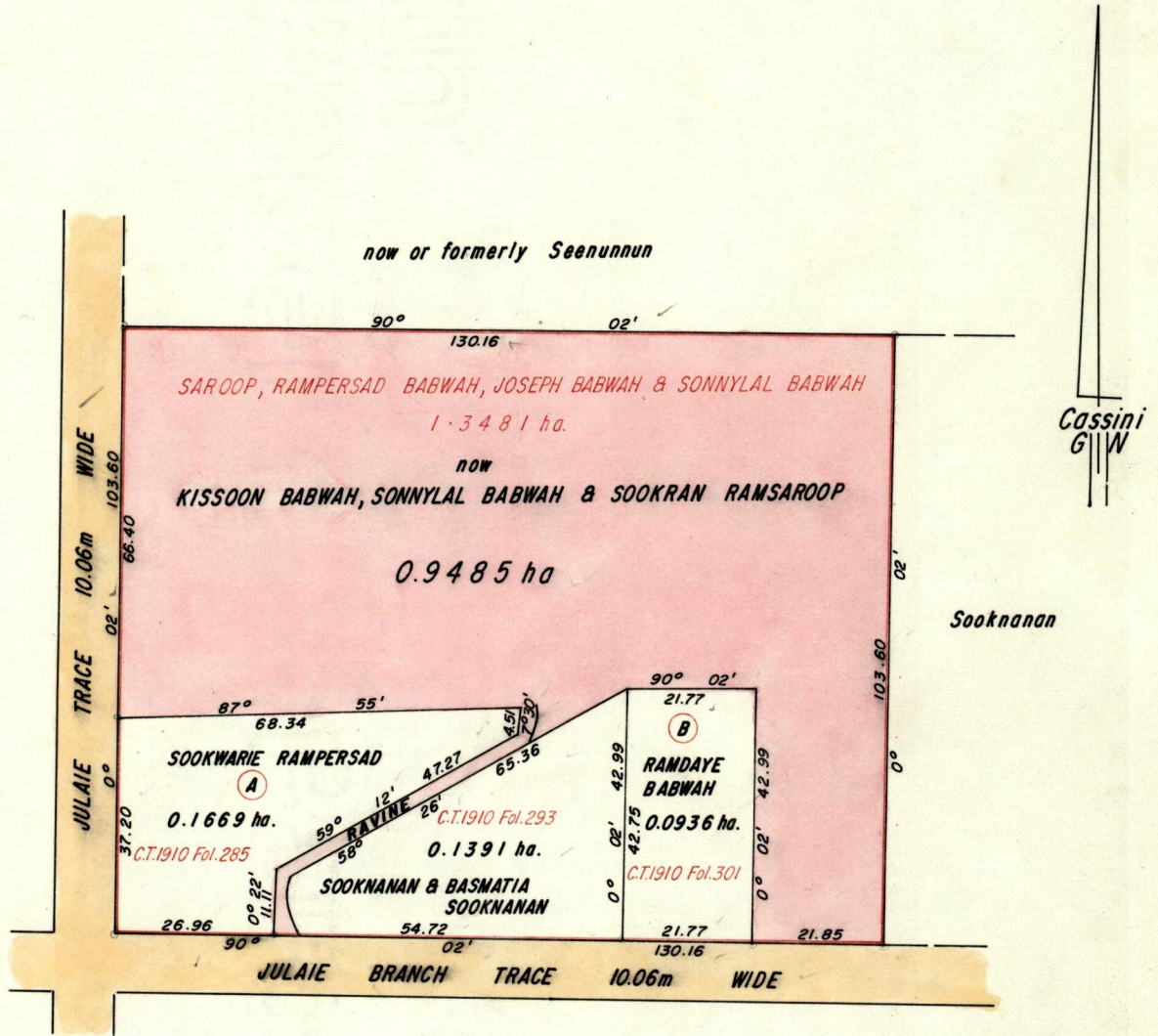

Approved

*James Charles*  
Director of Surveys  
9.06.12

SCALE 1:1250

Note: To obtain compass bearings <sup>add</sup> 2 minutes <sub>subtract</sub>

Distances are in Metres

This is a true copy of a diagram of one point three four eight one hectares originally transferred granted to Saroop, Rampersad Babwah, Joseph Babwah, Kisson Babwah & Sonnylal Babwah, shewing a portion coloured pink and containing zero point nine four eight five hectares being the remainder after 3 previous transfers of other portions of the land. 14(2)(d) of the Land Surveyors Ordinance 1952 ~~7(d) of Cap. 27, No. 2~~ and duly certified by the Director of Surveys.

Checked by *S. J. 9.6.11*

Entered on

*Ganesh Ramcharan*  
Land Surveyor, Trinidad, 31/5/91 19.....

Previous Survey - bk 903 fol. 9