

No 26499

1198

2883

R.P.O. Vol. 22.  
C.T. Vol. 2713.

Fol. 325.  
Fol. 515.

Ward of Montserrat.  
County of Nariva.  
Cadastral Sheet D. 19. H.  $\frac{44F}{1/b}$ .

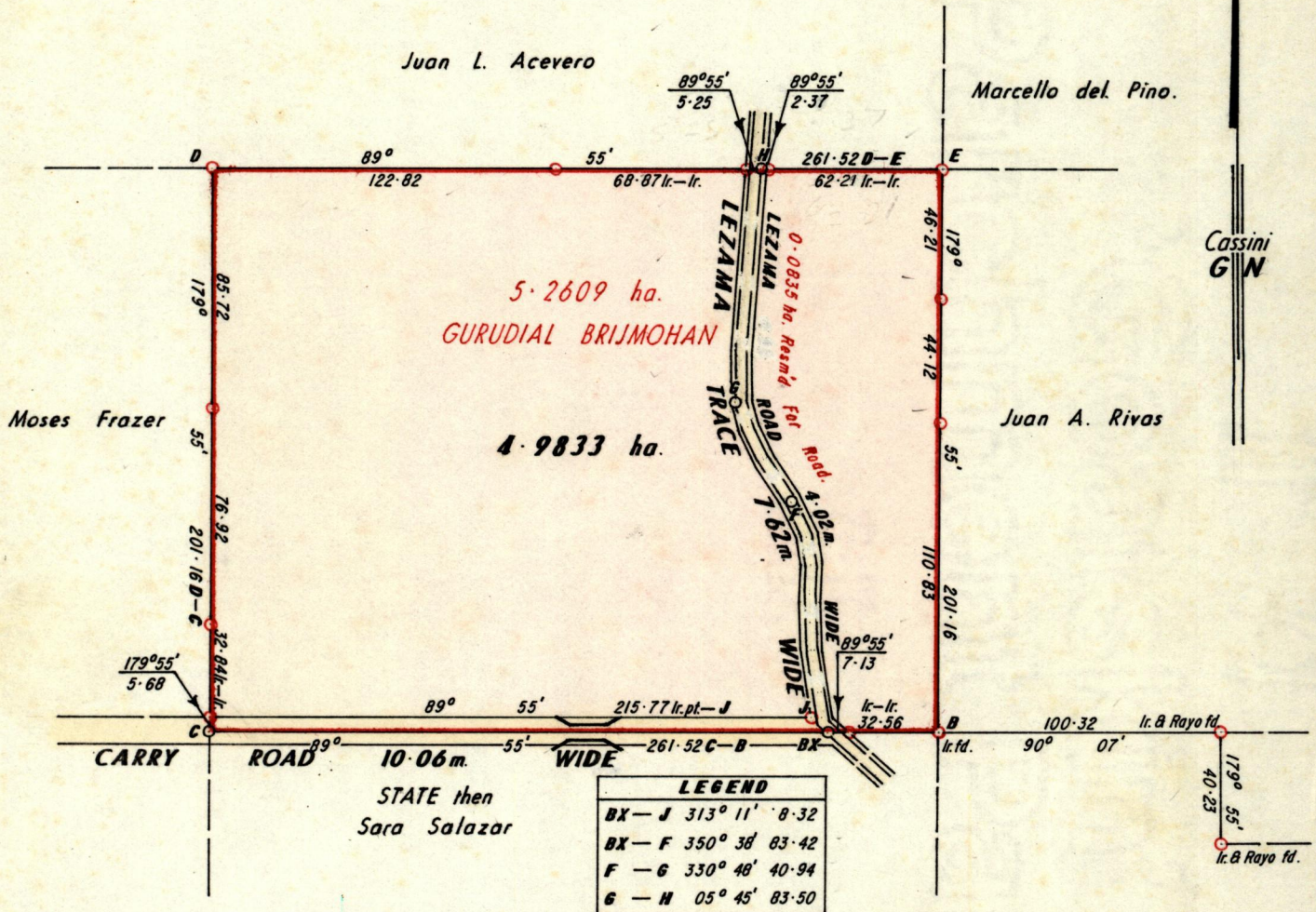

15/9/92

Approved

*Law Charles*

Director of Surveys 92-09-15

○ Denotes Iron put except otherwise stated.

Cassini Grid bearings based on Solar Observations.

SCALE 1:2500.

Note: To obtain compass bearings add/minutes 05

Distances are in metres.

PLAN of a Parcel of land coloured pink in the Ward of Montserrat.

Containing four point nine eight three three hectares.

Surveyed by me, with due authority, in April 1990.

I certify that I have complied with rule 76 under section 14(2)(d) of the Land Surveyors' Ordinance 1952, and that this plan is correct.

Checked by *G. Ramcharan, Sr*  
14/9/92

*Winston Ramcharan*

Entered .....

Land Surveyor, Trinidad 22nd June 1990  
and Tobago



Original. Survey Bk. 255:109

33

33

Vertical text on the left side, possibly bleed-through from the reverse side of the page.

Faint, illegible text in the middle section of the page.

Faint, illegible text at the bottom of the page, possibly bleed-through or very light handwriting.